

May 19, 2022

AMENDED AGENDA FOR DELTA COUNTY COMMISSIONERS COURT

Meeting time is 9:00 AM, Monday, May 23, 2022 in the District Courtroom on the Second Floor of the Delta County Courthouse, located at 200 West Dallas Avenue, Cooper, Texas 75432.

Order
Pledge of Allegiance
Invocation
Announcements

AGENDA

FILED FOR RECORD
AT 9:00 A M
MAY 19 2022

Jane Jones, County Clerk
DELTA COUNTY, TEXAS

1. Public participation
2. Discuss and possible action – Approve Commissioners Court minutes of May 9, 2022 – Jane Jones
3. Discuss and possible action – Establish width of county roads in Enel Solar Project area – Mark Brantley
4. Discuss and possible action – Enel Green Power Estonian Solar Project, LLC submitting Estonian's Road Improvement Plan – Zach Precopia
5. Discuss and possible action – Budget line item transfer from Insurance G.L. to Contingency G.L. to Fund refund of PPF – Debbie Huie
6. Discuss and possible action - Jail Report – Chief Deputy Alex Suarez
7. Discuss and possible action - Payment of Bills – Jennifer Houchins
8. Adjourn

Reminder of Texas Government Code Chapter 551 regarding open meetings that if a member of the public or of the Board inquires about a subject that is not on the agenda, and for which notice has not been given as required any discussion of or decision about the subject of the inquiry shall be limited to a proposal to place the subject on the agenda for a future meeting.

This notice is given pursuant to "Section 551.002, Government Code"; and the notice shall be posted at the Courthouse, being a place convenient to the public, for at least 3 days.

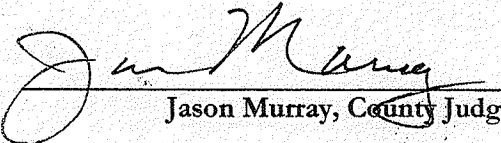
Jason Murray, County Judge

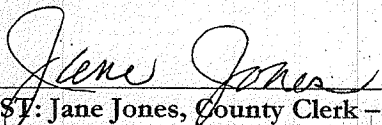
ATTEST: Jane Jones, County Clerk – May 19, 2022

DELTA COUNTY COMMISSIONERS COURT

REGULAR TERM, MAY 23, 2022

BE IT REMEMBERED THAT A MEETING OF THE DELTA COUNTY COMMISSIONERS COURT WAS HELD THIS DAY AT THE COURTHOUSE IN COOPER, TEXAS.

THOSE ATTENDING WERE:

MORGAN BAKER, COM. PREC. #1

JIMMY SWEAT, COM. PREC. #2

ANTHONY ROBERTS, COM. PREC. #3

MARK BRANTLEY, COM. PREC. #4

MEETING WAS CALLED TO ORDER BY JUDGE PRO-TEM MARK BRANTLEY.

PLEDGE OF ALLEGIANCE WAS LED BY JUDGE PRO-TEM MARK BRANTLEY.

INVOCATION WAS GIVEN BY MS. SUE HOMMEL.

ANNOUNCEMENTS: LET THE RECORD SHOW THAT JUDGE MURRAY IS NOT PRESENT THIS MORNING.

AGENDA

1. PUBLIC PARTICIPATION: NONE
2. DISCUSS AND POSSIBLE ACTION-APPROVE COMMISSIONERS COURT MINUTES OF MAY 9, 2022-JANE JONES.

COMMISSIONER BAKER- I MAKE THE MOTION TO APPROVE THE MINUTES OF MAY 9, 2022.

COMMISSIONER SWEAT- SECOND

JUDGE PRO-TEM= MOTION MADE AND SECOND TO APPROVE THE MINUTES OF MAY 9, 2022 AS PRESENTED. ANY DISCUSSION? COURT VOTES? 4 TO 0, AYES HAVE IT, MOTION CARRIED.

3. DISCUSS AND POSSIBLE ACTION-ESTABLISH WIDTH OF COUNTY ROADS IN ENEL SOLAR PROJECT ATEA-MARK BRANTLEY.

MR. BRANTLEY STATED THAT ITEM 3 AND 4 WOULD BE DISCUSSED AT THE SAME TIME.

4. DISCUSS AND POSSIBLE ACTION-ENEL GREEN POWER ESTONIAN SOLAR PROJECT LLC SUBMITTING ESTONIAN ROAD IMPROVEMENT PLAN-ZACH PRECOPIA.

MR. PRECOPIA MADE A CONFERENCE CALL TO MEREDITH SAVAGE AND MR. JEREMY RICE.

SEE ATTACHED

THERE ARE 7 COUNTY ROADS

ROADS ARE TO BE 16 FT WIDE WITH A MAXIMUM OF 20" WITH INCLUDING THE DITCHES. 6" CRUSHED BAS WITH 8" LIMESTONE UNDERNEATH E.

COMMISSIONER SWEAT: I MAKE THE MOTION TO APPROVE THE ESTONIAN ROAD IMPROVEMENT PLAN AS PRESENTED.

COMMISSIONER ROBERTS: SECOND

JUDGE PRO-TEM: MOTION MADE AND SECONDED TO APPROVE THE ESTONIAN ROAD IMPROVEMENT PLAN. ANY DISCUSSION? COURT VOTES? 3 TO 0, AYES HAVE IT, MOTION CARRIED COMMISSIONER BAKER ABSTAINED.

5. DISCUSS AND POSSIBLE ACTION-BUDGET LINE ITEM TRANSFER FROM INSURANCE G.L. TO CONTINGENCY G.L. TO FUND REFUND OF PPF-DEBBIE HUIE.

THE REFUND WOULD BE \$21,297.20 FROM GENERAL AND \$1,362.44 FROM EACH PRECINCT.

SEE ATTACHED.

COMMISSIONER BAKER: I MAKE THE MOTION TO MAKE A LINE ITEM TRANSFER FROM INSURANCE G. L. TO FUND REFUND OF PPL.

COMMISSIONER SWEAT: SECOND

JUDGE PRO-TEM: MOTION MADE AND SECOND TO APPROVE THE LINE ITEM TRANSFER FROM INSURANCE G.L. TO CONTINGENCY TO FUND THE REFUND TO PPL. ANY DISCUSSION? COURT VOTES? 4 TO 0.

6. DISCUSS AND POSSIBLE ACTION- JAIL REPORT-CHIEF DEPUTY ALEX SUAREZ.

DEPUTY SUAREZ STATED THERE WAS 14 IN JAIL HAVE 3 VACANCIES INSIDE THE JAIL.

7. DISCUSS AND POSSIBLE ACTION – PAYMENT OF BILLS-JENNIFER HOUCHINGS.

COMMISSIONER BAKER- I MAKE THE MOTION TO PAY ALL BILLS AS PRESENTED.

COMMISSIONER SWEAT; SECOND

JUDGE PRO-TEM- MOTION MADE AND SECOND TO PAY ALL BILLS AS PRESENTED. ANY DISCUSSION? COURT VOTES? 4 TO 0, AYES HAVE IT, MOTION CARRIED.

8. ADJOURN

IF THERE IS NO FURTHER BUSINESS, THIS MEETING IS ADJOURNED.



Enel Green Power Estonian Solar Project, LLC
A subsidiary of: Enel Green Power North America, Inc.

100 Brickstone Square, Suite 300 – Andover, MA 01810 – USA
T +1 978 681 1900 – F +1 978 681 7727

May 17, 2022

Commissioner Mark Brantley
200 W. Dallas Avenue
Cooper, TX 75432

Dear Commissioner Brantley,

Enel Green Power Estonian Solar Project, LLC, (Estonian) is submitting Estonian's Road Improvement Plan for review in the Commissioners Court. Included with this package is a letter of Certifications Regarding Road Improvements, which we would ask Delta County to countersign should it agree. The project proposes improvements to seven county roads, five of which will have improved driveways onto FM 2949, and one with an improved driveway onto FM 198 W (see summary table below). County roads will be designed for a minimum width of 16 feet to a maximum width of 20 feet depending on location, and interior access roads will have a width of 12 feet.

County Road	Total Access Driveways (Internal and CR to CR)	Total Driveways onto FM 2949	Total Driveways onto FM 198 W
4825	6	1	-
4820	1	1	-
4815	2	2	-
4810	2	1	-
4430	6	1	-
4345	3	-	1
4343	1	-	-

Attachment A provides the overall road plan and delivery flow for the project roads (Sheet C.700) and includes the road improvements, driveway details, locations, and culvert sizing for all project roads except for CR 4825. Attachment B includes these same details for CR 4825. The collection crossing details have not been finalized and will be submitted as a separate plan at a later date.

Estonian appreciates your consideration of this plan and would begin construction upon acceptance.

Sincerely,

Meredith Savage

May 17, 2022

County Commissioners
Delta County
200 W. Dallas Ave.
Cooper, TX 75432

RE: Certifications Regarding Road Improvements

Dear Commissioners:

Enclosed within this submittal is a Road Improvement Plan dated May 17, 2022 ("Road Improvement Plan"). Enel Green Power Estonian Solar Project, LLC ("Estonian") requests confirmation by the County by signing and acknowledging the following statements below in relation to the road improvements that Estonian plans to undertake for Delta County ("County") pursuant to the Road Improvement Plan.

County certifies that it has:

- (a) continuously maintained the relevant roads to be improved subject to Road Improvement Plan since at least August 31, 1981;
- (b) adopted a road map pursuant to Texas Transportation Code Section 258.002; and
- (c) approved the Road Improvement Plan based on its compliance with such County road map for the location and width of such roads.

Further, County acknowledges that Estonian is relying upon these certifications for purposes of establishing the location and width of such roads. As such, County shall defend, indemnify, and hold harmless Estonian from and against any and all claims, loss, damage and expense to the extent arising out of or caused by Estonian's trespass or encroachment (or perceived trespass or encroachment) on property adjacent to the roads in performance of such road improvements.

Sincerely,

Enel Green Power Estonian Solar Project, LLC

AGREED AND ACKNOWLEDGED BY:

DELTA COUNTY, TEXAS

By: _____

Name : _____

Title: _____

ATTACHMENT A

- LEGEND:**
- PROJECT BOUNDARY
 - RIGHT OF WAY LINES
 - GRAVEL ROAD
 - PROPOSED SOLAR ARRAY
 - PROPOSED ACCESS ROAD
 - PROPOSED LOW WATER CROSSING
 - PROPOSED ENTRANCE CULVERT
 - PROPOSED ELECTRICAL EQUIPMENT
 - PROPOSED LAYDOWN YARD
 - PROPOSED DRILL SITE
 - PROPOSED CULVERT
 - PROPOSED INGRESS
 - PROPOSED EGRESS
 - PROPOSED IMPROVED PUBLIC ROAD



Westwood
 12700 West 146th Avenue, Suite 1000
 Greenwood Village, CO 80122
 Phone: 303.555.5500
 Fax: 303.555.5505
 www.westwoodgroup.com

P3C
Primoris
 3800 Levinston Street, Suite 300
 Aurora, CO 80011

REVISION	DATE	COMMENTS
A.	05/12/2022	REV. CIVIL ENGINEER SET.
B.	05/12/2022	REV. CIVIL ENGINEER SET. (SEE 15/15/2022)
C.	05/12/2022	REV. CIVIL ENGINEER SET. (SEE 15/15/2022)
C1.	05/12/2022	REV. CIVIL ENGINEER SET. REV.

DATE	BY	CHECKED	DATE	BY	CHECKED
05/12/2022	DL	DL	05/12/2022	DL	DL

Green Power
 12700 West 146th Avenue, Suite 1000
 Greenwood Village, CO 80122
 Phone: 303.555.5500
 Fax: 303.555.5505
 www.greenpower.com

Estonian Solar Project
 Delta County, Texas

Delivery Flow Plan - Overall

NOT FOR CONSTRUCTION
 DATE: 05/12/2022
 SHEET: C.700

NO.	DATE	COMMENT
A.	10/16/2022	10% CIVIL DESIGN SET
B.	01/07/2023	20% CIVIL DESIGN SET - 10% & 15% MODIFIES
C.	05/07/2023	60% CIVIL DESIGN SET - 10% & 15% MODIFIES
D.	05/12/2022	60% CIVIL DESIGN SET - REV

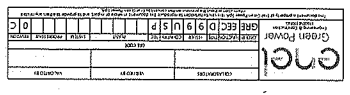

Estonian Solar Project
 Delta County, Texas

Entrance Exhibits -
 County Road 4825
 Entrances 01 & 02

NOT FOR CONSTRUCTION
 DATE: 05/12/2022
 SHEET: C.800

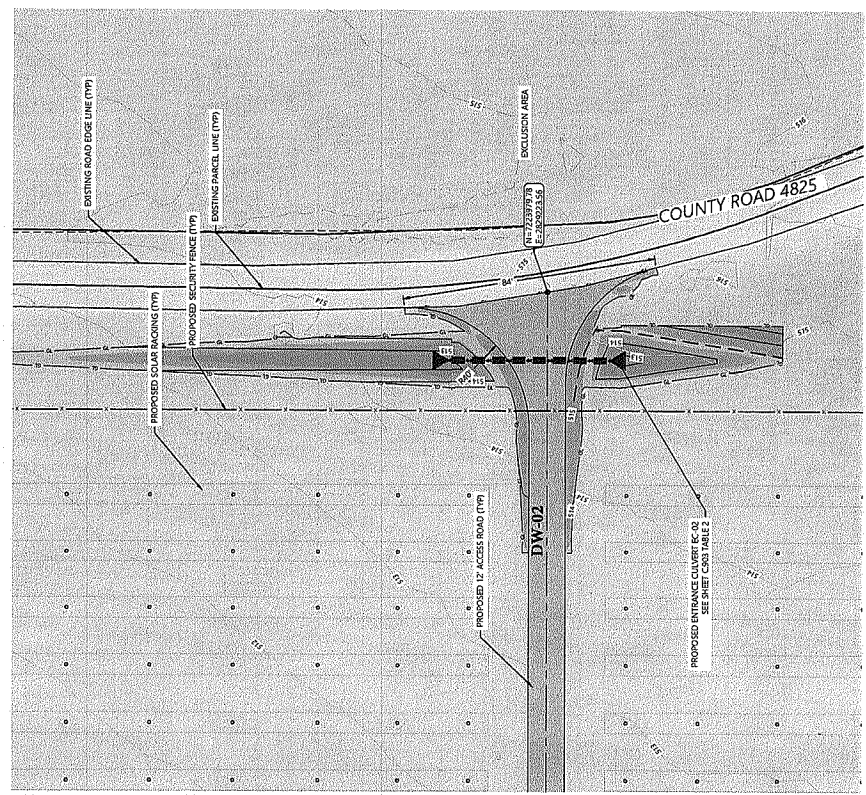

DW-02 COUNTY ROAD 4825 ENTRANCES 02

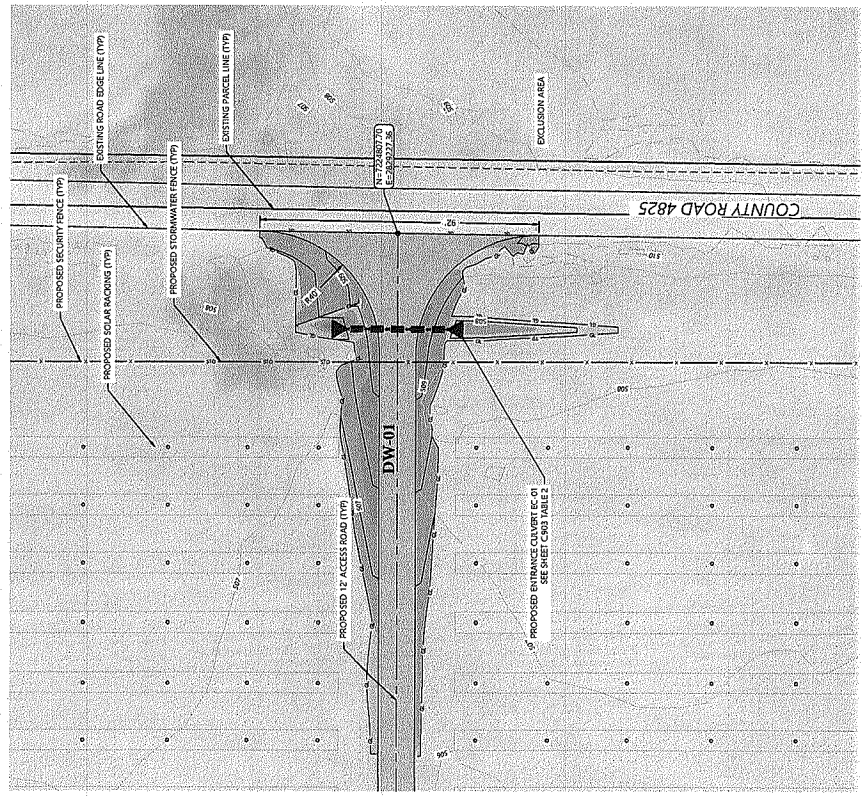

DW-01 COUNTY ROAD 4825 ENTRANCES 01

LEGEND:

	PROJECT BOUNDARY
	PARCEL SECTION LINES
	PARCEL BOUNDARY
	EASEMENT LINES
	EXISTING GAS LINE
	EXISTING WATER LINE
	EXISTING OVERHEAD POWER
	EXISTING POWER CONVERSION UNIT
	EXISTING 5' INDEX CONTOUR
	PROPOSED 5' INDEX CONTOUR
	PROPOSED 1' INTERVAL CONTOUR
	PROPOSED LIS ARRAY
	PROPOSED SIL FENCE
	PROPOSED ACCESS ROAD

NOTE:
 * TEMPORARY INUNDATION BOUNDARY SHOWN FROM 24-HOUR STORM EVENT. AVOID STORAGE IN THESE AREAS.

- NOTES:**
- CONTRACTOR TO INSTALL 12' DELIVERY ACCESS ROAD STRUCTURAL CROSS SECTION UP TO THE EDGE OF THE EXISTING RIGHT-OF-WAY
 - SEE DETAIL C.807 FOR ROCK CONSTRUCTION ENTRANCE
 - SEE DETAIL C.808 FOR ROAD SUBGRADE
 - COORDINATE EXISTING AND NEW TRAILER STALLS, CENTRAL ZONE, BASE PLOT
 - ENTRANCE CULVERTS ARE SIZED TO MEET THE 10-YEAR, 24-HOUR STORM EVENT PER TxDOT SPECIFICATIONS

NOTE:

- STRUCTURAL SECTIONS SHOWN ARE THE MINIMUM THICKNESS REQUIREMENTS DURING NORMAL FIELD CONDITIONS. THE SECTIONS MAY NEED TO BE THICKENED FOR SPECIAL CONSTRUCTION CONDITIONS INCLUDE BUT ARE NOT LIMITED TO:
 - IF THE ROAD SUBGRADE IS SOFT OR MUDDY, THE SURFACE SHALL BE SCARIFIED, DREDGED AND RECOMPACTED TO ACHIEVE COMPACTION
 - ROAD DESIGN BASED ON GEOTECHNICAL INVESTIGATION REPORT PREPARED BY KLENFELDER DATED JANUARY 18, 2021.
 - ROADS TO BE MAINTAINED PER THE PROCEDURES OUTLINED IN THE PROJECT GEOTECHNICAL REPORT.

6" CRUSHED GRAVEL BASE
 6" LIME STABILIZED SUBGRADE
 12' DELIVERY ACCESS ROAD CROSS SECTION

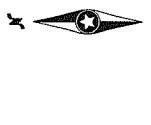

PROPOSED ACCESS ROAD CROSS SECTION	01
------------------------------------	----

NO.	DATE	COMMENT
A	10/20/2021	ISSUE FOR PERMIT
B	01/09/2022	REVISED FOR PERMIT
C	06/02/2022	REVISED FOR PERMIT
CL	06/17/2022	REVISED FOR PERMIT



Estonian Solar Project
 Delta County, Texas

Entrance Exhibits -
 County Road 4825
 Entrance 06

NOT FOR CONSTRUCTION
 DATE 05/12/2022
 SHEET: C.802

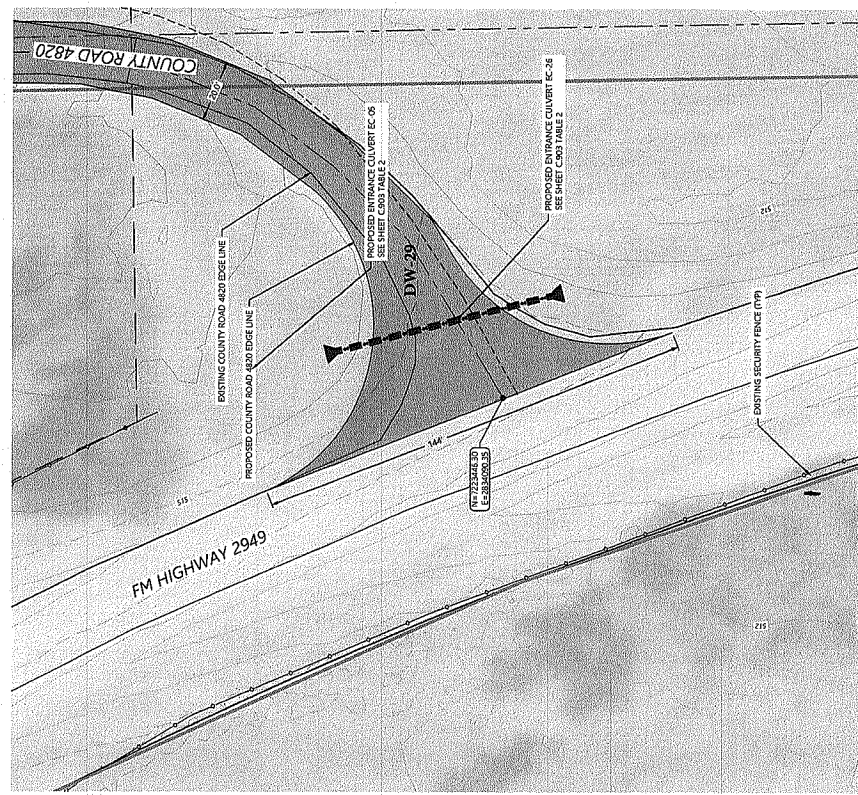

DW-29 COUNTY ROAD 4820 - FM 2949 ENTRANCES 01
 (out of sequence number)

- NOTES:
- CONTRACTOR TO INSTALL 12" DELIVERY ACCESS ROAD STRUCTURAL CROSS SECTION UP TO THE EDGE OF THE EXISTING RIGHT-OF-WAY
 - SEE DETAIL C.807 OF PERMITS FOR ROAD CONSTRUCTION ENTRANCE
 - EXISTING ROAD SUBGRADE IS SOFT OR MUDDY, THE SUBGRADE SHALL BE SCARIFIED, DRIED AND RECOMPACTED TO ACHIEVE COMPACTION
 - COORDINATE SYSTEM IS NAD83 TEXAS STATE PLANNING CENTRAL ZONE, UTM ZONE 18S
 - ENTRANCE CULVERTS ARE SIZED TO MEET THE 10-YEAR, 24-HOUR STORM EVENT PER TROTT SPECIFICATIONS

NOTE:

- STRUCTURAL SECTIONS SHOWN ARE THE MINIMUM THICKNESS REQUIREMENTS DURING NORMAL FIELD CONDITIONS. THE SECTIONS MAY NEED CONSTRUCTION DURINGS UNUSUALLY WET PERIODS OR IN LOWWATER AREAS.
- IF THE ROAD SUBGRADE IS SOFT OR MUDDY, THE SUBGRADE SHALL BE SCARIFIED, DRIED AND RECOMPACTED TO ACHIEVE COMPACTION
- ROAD DESIGNER BASED ON GEOTECHNICAL INVESTIGATION REPORT PREPARED BY KLEINFELDER DATED JANUARY 18, 2021.
- ROADS TO BE MAINTAINED PER THE PROCEDURES OUTLINED IN THE PROJECT GEOTECHNICAL REPORT.

6" CURBED GRAVEL BASE
 6" LIME STABILIZED SUBGRADE
 12" DELIVERY ACCESS ROAD CROSS SECTION

PROPOSED ACCESS ROAD CROSS SECTION

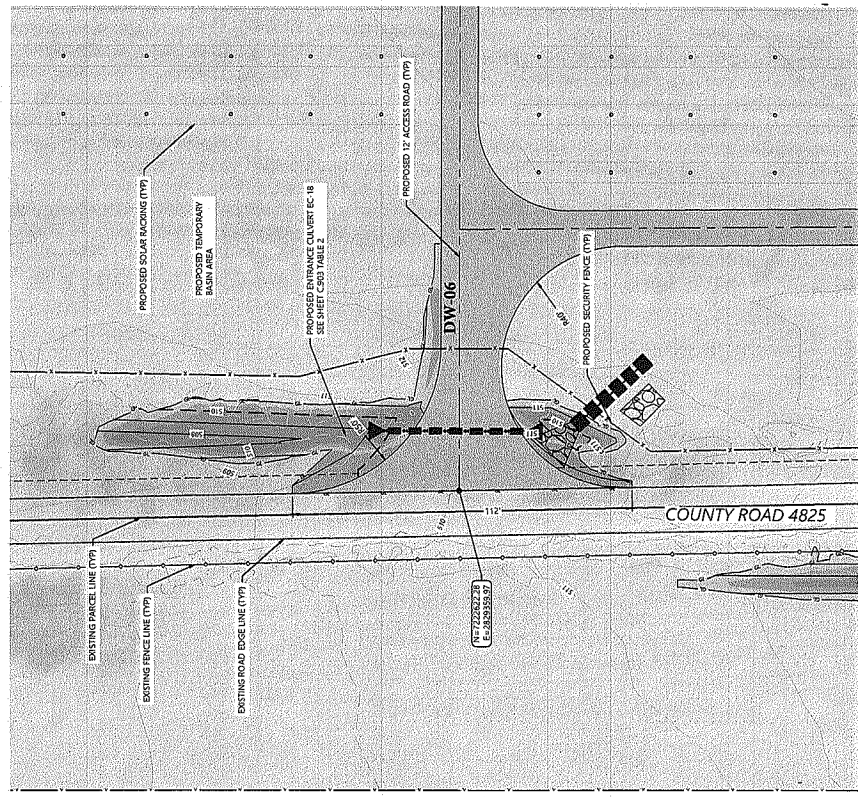

DW-06 COUNTY ROAD 4825 ENTRANCES 06

- LEGEND:
- PROJECT BOUNDARY
 - PARCEL SECTION LINES
 - PARCEL BOUNDARY
 - EASEMENT LINES
 - EXISTING GAS LINE
 - EXISTING WATER LINE
 - EXISTING OVERHEAD POWER
 - EXISTING FENCE
 - EXISTING OVERHEAD POWER
 - PROPOSED L&L ARRAY
 - PROPOSED L&L FENCE
 - PROPOSED 5' INDEX CONTOUR
 - PROPOSED ACCESS ROAD
 - PROPOSED 12" DELIVERY ACCESS ROAD CROSS SECTION
 - PROPOSED 6" LIME STABILIZED SUBGRADE
 - PROPOSED 6" CURBED GRAVEL BASE
 - PROPOSED IMPROVED COUNTY HIGHWAY
 - PROPOSED PERIMETER SECURITY FENCE
 - PROPOSED POWER CONVERSION UNIT
 - EXISTING 5' INDEX CONTOUR
 - PROPOSED 5' INDEX CONTOUR
 - PROPOSED 1' INTERVAL CONTOUR

NOTE:
 * TEMPORARY INUNDATION BOUNDARY SHOWN FROM TEMPORARY EMBANKMENT CONTROL BERM DURING THE 2-YEAR, 24 HOUR STORM EVENT. NO SOIL STORAGE IN THESE AREAS.

NO.	DATE	COMMENT
A	10/20/2022	ISSUE FOR PERMIT
B	09/20/2022	FOR REVIEW
C	09/20/2022	FOR REVIEW
C1	09/20/2022	FOR REVIEW

PROJECT NO.	22-00000000
DATE	10/20/2022
PROJECT NAME	ESTONIAN SOLAR PROJECT
CLIENT	ESTONIAN SOLAR
DESIGNER	PRIMORIS
SCALE	AS SHOWN
BY	W. J. BROWN
CHECKED BY	W. J. BROWN
DATE	10/20/2022

Estonian Solar Project
 Delta County, Texas

Entrance Exhibits -
 County Road 4430
 #05 & County Road
 4820 #01

NOT FOR CONSTRUCTION
 DATE 05/12/2022
 SHEET: C.806

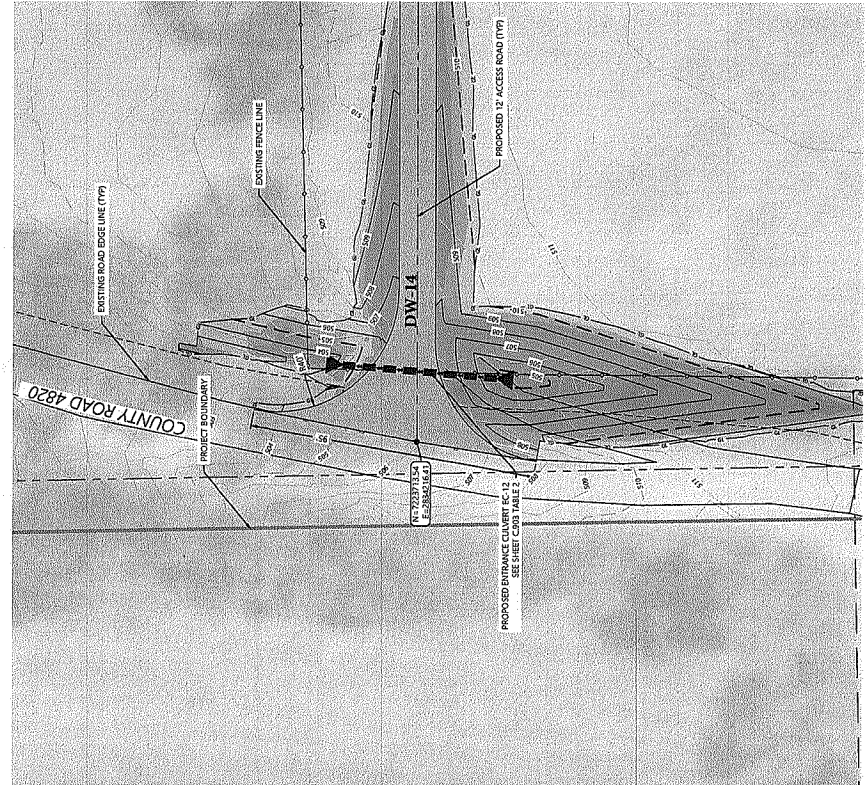

DW-14 COUNTY ROAD 4820 ENTRANCES 01

- NOTES:
- CONTRACTOR TO INSTALL 12' DELIVERY ACCESS ROAD STRUCTURAL CROSS SECTION UP TO THE EDGE OF THE EXISTING RIGHT-OF-WAY
 - SEE DETAIL C-807 FOR ROCK CONSTRUCTION ENTRANCE
 - SEE DETAIL C-808 FOR ROCK CONSTRUCTION ENTRANCE
 - COORDINATE SYSTEM IS NAD 83 STATE PLANNED, CENTRAL ZONE, UNIT FOOT
 - ENTRANCE CULVERTS ARE SIZED TO MEET THE 10-YEAR 24-HOUR STORM EVENT PER TxDOT SPECIFICATIONS

- NOTE:
- STRUCTURAL SECTIONS SHOWN ARE THE MINIMUM THICKNESS REQUIREMENTS DURING NORMAL FIELD CONDITIONS. THE SECTIONS MAY NEED TO BE THICKENED FOR CONSTRUCTION CONDITIONS. CONDITIONS INCLUDE BUT ARE NOT LIMITED TO:
 - IF THE ROAD SUBGRADE IS SOFT OR MUDDY, THE SUBGRADE SHALL BE SCARIFIED, DRIED AND RECOMPACTED TO ACHIEVE COMPACTION
 - ROAD DESIGN BASED ON GEOTECHNICAL INVESTIGATION REPORT PREPARED BY ALENFELDER DATED JANUARY 18, 2021.
 - ROADS TO BE MAINTAINED PER THE PROCEDURES OUTLINED IN THE PROJECT GEOTECHNICAL REPORT.

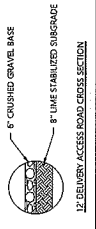

PROPOSED ACCESS ROAD CROSS SECTION 01

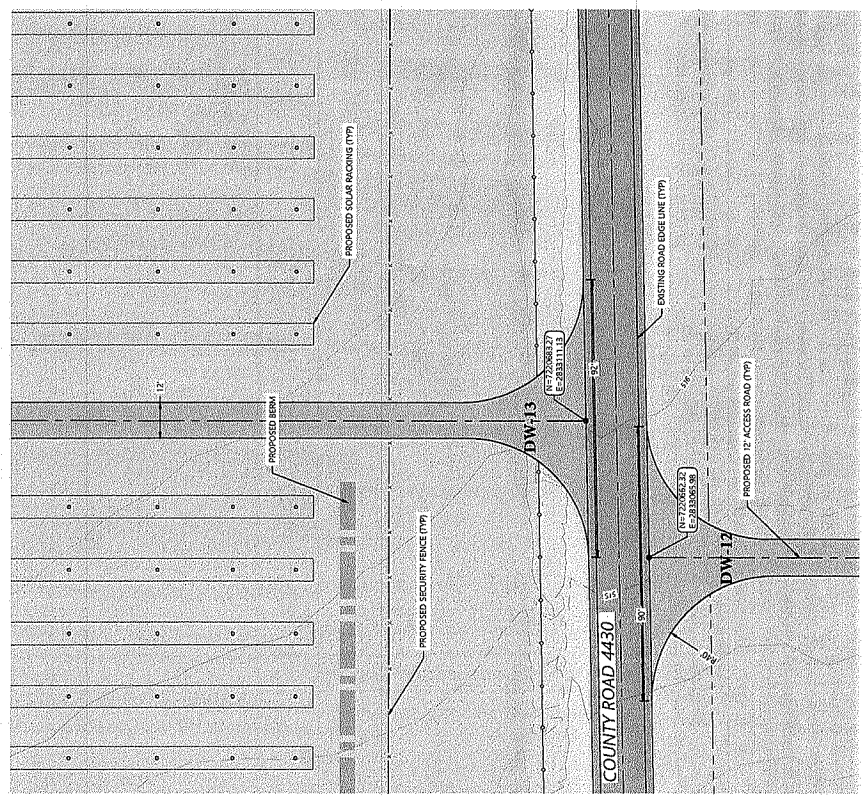

DW-13 COUNTY ROAD 4430 ENTRANCES 05

- LEGEND:
- PROJECT BOUNDARY
 - PARCEL SECTION LINES
 - PARCEL BOUNDARY
 - EASEMENT LINES
 - EXISTING GAS LINE
 - EXISTING TELEPHONE LINE
 - EXISTING WATER LINE
 - EXISTING PAVED ROAD
 - EXISTING UNPAVED ROAD
 - EXISTING FENCE
 - EXISTING OVERHEAD POWER
 - EXCLUSION AREA
 - PROPOSED US ARRAY
 - PROPOSED 8'x4' ARRAY
 - PROPOSED 5'x5' FENCE
 - PROPOSED BERM
 - PROPOSED ACCESS ROAD
 - PROPOSED BARN AREA
 - PROPOSED FILL
 - PROPOSED CONCRETE WASHOUT
 - STORMWATER CULVERT
 - PROPOSED IMPROVED COUNTY HIGHWAY
 - PROPOSED PERIMETER SECURITY FENCE
 - PROPOSED POWER CONVERSION UNIT
 - EXISTING 5' INDEX CONTOUR
 - EXISTING 2' INDEX CONTOUR
 - PROPOSED 2' INDEX CONTOUR
 - PROPOSED 1' INTERNAL CONTOUR

NOTE:
 * TEMPORARY INUNDATION BOUNDARY SHOWN FROM
 TEMPORARY SEDIMENT CONTROL BERM DURING THE 2-YEAR
 24-HOUR STORM EVENT. AVOID STORAGE IN THESE AREAS.



PREPARED FOR

P&C
Primoris
 3800 Lewiston Street, Suite 300
 Aurora, CO 80011

NO.	DATE	COMMENT
A.	10/20/2022	ISSUE FOR PERMIT
B.	09/20/2022	ISSUE FOR PERMIT
C.	09/20/2022	ISSUE FOR PERMIT
CL	09/20/2022	ISSUE FOR PERMIT

PROJECT NO.	131515
DATE	05/12/2022
PROJECT NAME	ESTONIAN SOLAR PROJECT
PROJECT LOCATION	DELTA COUNTY, TEXAS
PROJECT DESCRIPTION	DELTA COUNTY ROAD 4810 ENTRANCES
PROJECT STATUS	ISSUE FOR PERMIT
PROJECT PHASE	DESIGN
PROJECT TYPE	ROADWAY
PROJECT OWNER	ESTONIAN SOLAR
PROJECT CONTACT	ALAN WILSON
PROJECT PHONE	281.352.1500
PROJECT FAX	281.352.1505
PROJECT EMAIL	awilson@westwood.com
PROJECT WEBSITE	www.westwood.com

Estonian Solar Project

Delta County, Texas

Entrance Exhibits -
 County Road 4810
 Entrances 01 & 02

NOT FOR CONSTRUCTION

DATE 05/12/2022

SHEET: C.807

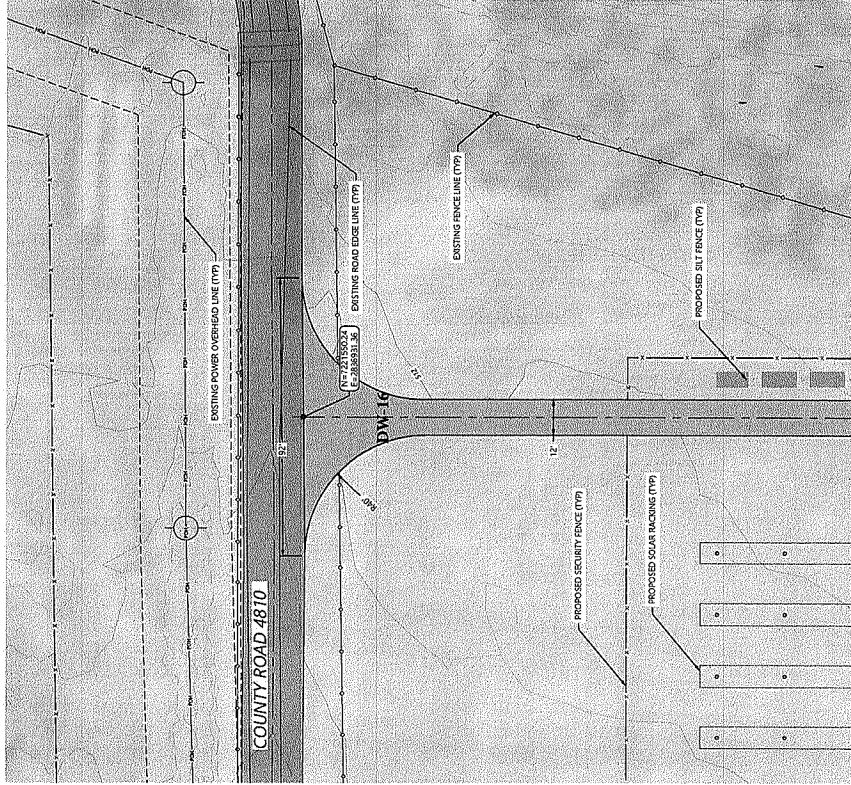

DW-16 COUNTY ROAD 4810 ENTRANCES 02

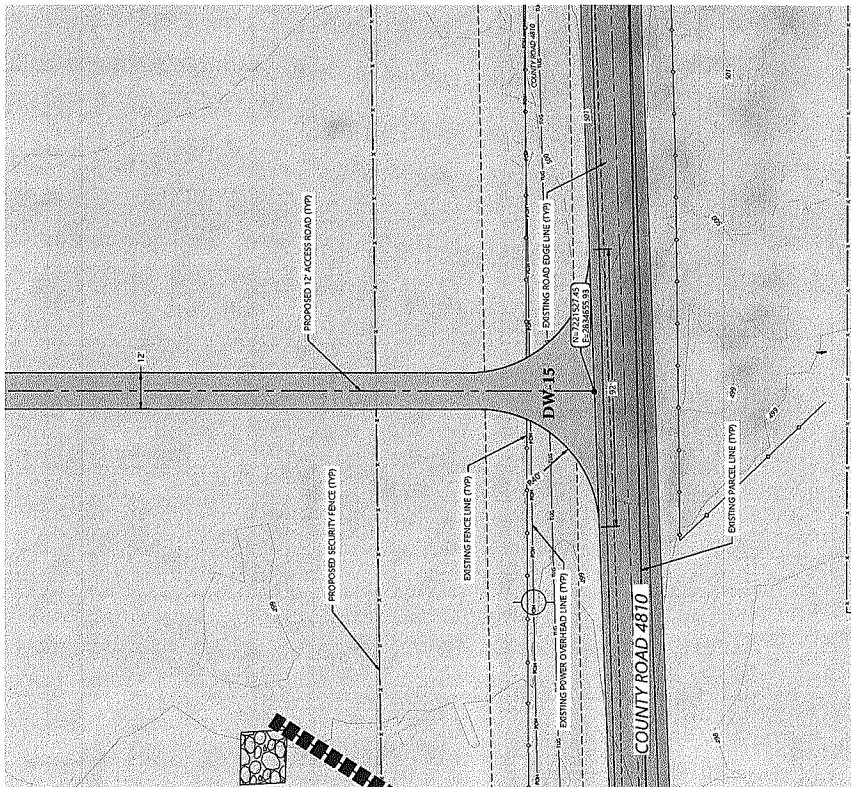

DW-15 COUNTY ROAD 4810 ENTRANCES 01

- LEGEND:**
- PROJECT BOUNDARY
 - PARCEL SECTION LINES
 - PARCEL BOUNDARY
 - BASEMENT LINES
 - EXISTING GAS LINE
 - EXISTING WATER LINE
 - EXISTING POWER OVERHEAD LINE
 - EXISTING FENCE
 - EXISTING OVERHEAD POWER
 - EXISTING US ARMY
 - PROPOSED IRI ARRAY
 - PROPOSED SILT FENCE
 - PROPOSED SECURITY FENCE
 - PROPOSED ACCESS ROAD
 - PROPOSED BARRICADE
 - PROPOSED CONCRETE WASHOUT
 - STORMWATER CULVERT
 - PROPOSED IMPROVED COUNTY HIGHWAY
 - PROPOSED PRIMER SECURITY FENCE
 - PROPOSED POWER CONVERSION UNIT
 - EXISTING 5' INDEX CONTOUR
 - PROPOSED 5' INDEX CONTOUR
 - PROPOSED 1' INTERVAL CONTOUR

- NOTES:**
1. CONTRACTOR TO INSTALL 12' DELIVERY ACCESS ROAD STRUCTURAL CROSS SECTION UP TO THE EDGE OF THE EXISTING RIGHT OF WAY
 2. SEE DETAIL C.807 FOR ROCK CONSTRUCTION ENTRANCE
 3. ROAD DESIGN SHALL BE IN ACCORDANCE WITH THE TEXAS STATE PLANS, GENERAL ZONE III, 4' FOOT
 4. COORDINATE CULVERTS ARE TO MEET THE 10 YEAR, 24-HOUR STORM EVENT PER TxDOT SPECIFICATIONS
 5. ENTRANCE CULVERTS ARE TO MEET THE 10 YEAR, 24-HOUR STORM EVENT PER TxDOT SPECIFICATIONS

- NOTE:**
1. STRUCTURAL SECTIONS SHOWN ARE THE MINIMUM THICKNESS REQUIREMENTS DURING NORMAL FIELD CONDITIONS. THE SECTIONS MAY NEED TO BE THICKENED FOR ROCK CONSTRUCTION ENTRANCE. CONDITIONS INCLUDE BUT ARE NOT LIMITED TO CONSTRUCTION DURING UNUSUALLY WET PERIODS, OR IN LOWWATER AREAS.
 2. ROADWAY SURFACE SHALL BE SCARIFIED, DRIED AND RECOMPACTED TO ACHIEVE COMPACTION.
 3. ROAD DESIGN BASED ON GEOTECHNICAL INVESTIGATION REPORT PREPARED BY KLEINFELDER DATED JANUARY 18, 2021.
 4. ROADS TO BE MAINTAINED PER THE PROCEDURES OBTAINED IN THE PROJECT GEOTECHNICAL REPORT.



PROPOSED ACCESS ROAD CROSS SECTION

PROPOSED ACCESS ROAD CROSS SECTION

NOTE:
 TEMPORARY FOUNDATION BOUNDARY SHOWN FROM
 * TEMPORARY SEDIMENT CONTROL BERM DURING THE 2-YEAR,
 24-HOUR STORM EVENT - AVOID STORAGE IN THESE AREAS.

NO.	DATE	COMMENT
A.	10/26/2021	ISSUE FOR PERMIT
B.	07/07/2021	ISSUE FOR PERMIT
C.	06/02/2021	ISSUE FOR PERMIT
D.	05/12/2021	ISSUE FOR PERMIT

NO.	DATE	COMMENT
1.	05/12/2022	ISSUE FOR CONSTRUCTION

Estonian Solar Project

Delta County, Texas

Entrance Exhibits - FM 2949 Entrances

NOT FOR CONSTRUCTION

DATE 05/12/2022

SHEET: C.810

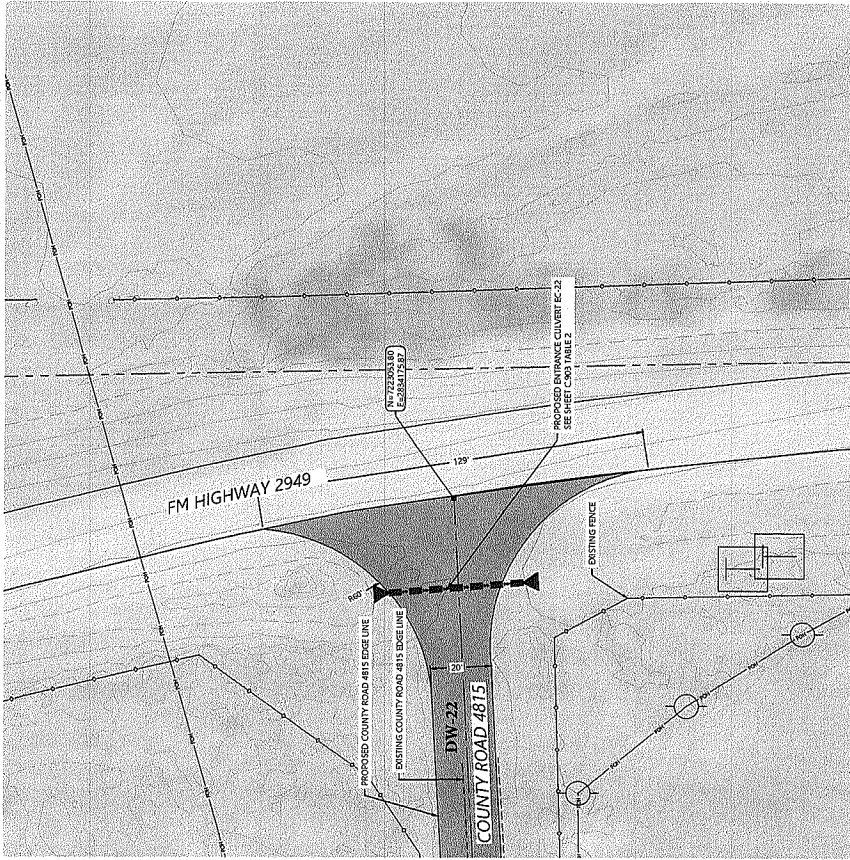

DW-22 COUNTY ROAD 4815 - FM 2929 ENTRANCE 02

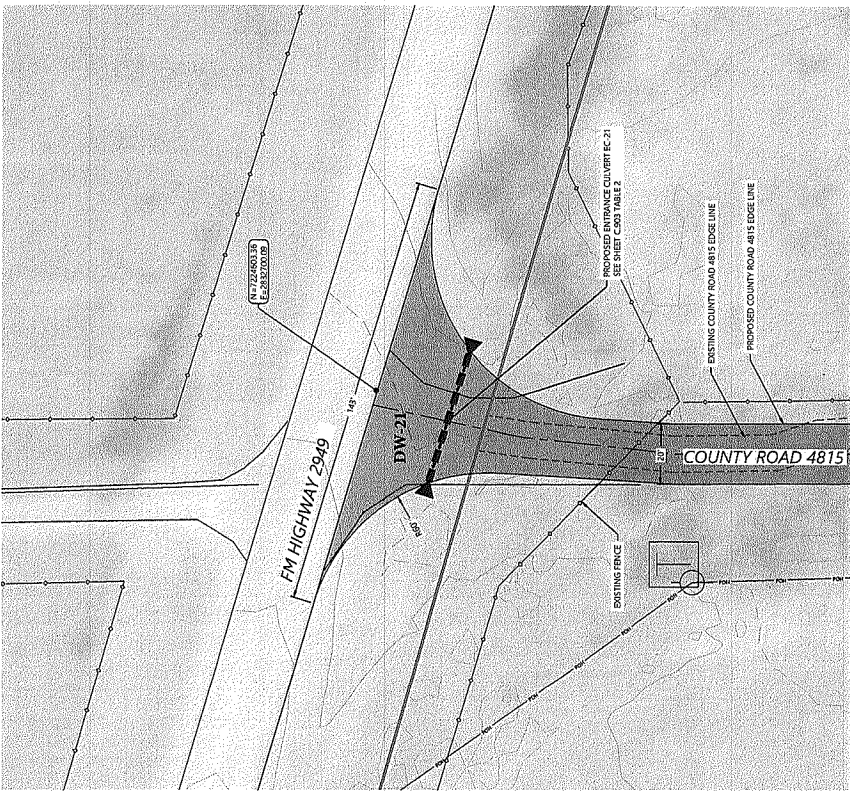

DW-21 COUNTY ROAD 4815 - FM 2929 ENTRANCE 01

LEGEND:

	PROJECT BOUNDARY		PROPOSED BASIN AREA
	PARCEL SECTION LINES		PROPOSED FILL
	EASEMENT LINES		STORMWATER WASHOUT
	EXISTING GAS LINE		PROPOSED IMPROVED COUNTY HIGHWAY
	EXISTING WATER LINE		PROPOSED PERIMETER SECURITY FENCE
	EXISTING POWER LINE		PROPOSED POWER CONVERSION UNIT
	EXISTING FENCE		EXISTING 5' INDEX CONTOUR
	EXCLUSION AREA		PROPOSED 5' INDEX CONTOUR
	PROPOSED US ARMY		PROPOSED 1' INTERVAL CONTOUR
	PROPOSED LRA ARRAY		PROPOSED ACCESS ROAD
	PROPOSED SILT FENCE		
	PROPOSED ACCESS ROAD		

NOTE:
 * TEMPORARY ILLUMINATION BOUNDARY SHOWN FROM 24 HOUR STORM EVENT. ADD'S CHANGE IN THESE AREAS

- NOTES:**
- CONTRACTOR TO INSTALL 20' IMPROVED COUNTY ROAD ROAD STRUCTURAL CROSS SECTION UP TO THE EDGE OF THE EXISTING RIGHT-OF-WAY
 - SEE DETAIL C-807 FOR ROCK CONSTRUCTION ENTRANCE
 - SEE DETAIL C-808 FOR ROAD SURFACE AND FINISH GRADE OF THE EXISTING ROAD ELEVATIONS
 - COORDINATE SYSTEM IS NAD83 TEXAS STATE PLACES, CENTRAL ZONE, US FOOT
 - ENTRANCE CULVERTS ARE SIZED TO MEET THE 10-YEAR, 24-HOUR STORM EVENT PER TxDOT SPECIFICATIONS

- NOTE:**
- STRUCTURAL SECTIONS SHOWN ARE THE MINIMUM THICKNESS REQUIREMENTS DURING NORMAL FIELD CONDITIONS. THE SECTIONS MAY NEED TO BE REDESIGNED FOR CONSTRUCTION CONDITIONS. CONDITIONS INCLUDE BUT ARE NOT LIMITED TO: CONSTRUCTION DURING UNUSUALLY WET PERIODS, OR IN LOWWATER AREAS.
 - IF THE ROAD SURFACE IS SOFT OR MUDDY, THE SUBGRADE SHALL BE SCARIFIED, DRIED AND RECOMPACTED TO ACHIEVE COMPACTION
 - ROAD DESIGN BASED ON GEOLOGICAL INVESTIGATION REPORT PREPARED BY KLEINFELDER DATED JANUARY 18, 2021.
 - ROADS TO BE MAINTAINED PER THE PROCEDURES OUTLINED IN THE PROJECT GEOTECHNICAL REPORT

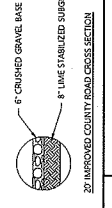

PROPOSED IMPROVED COUNTY ROAD CROSS SECTION

Westwood

01

NO.	DATE	COMMENTS
A.	10/26/2021	ISSUE FOR PERMIT
B.	03/09/2022	ISSUE FOR PERMIT
C.	05/12/2022	ISSUE FOR PERMIT

NO.	DATE	COMMENTS
1	05/12/2022	ISSUE FOR PERMIT

Estonian Solar Project
 Delta County, Texas

Entrance Exhibits - FM 2949 Entrances

NOT FOR CONSTRUCTION
 DATE: 05/12/2022
 SHEET: C.811

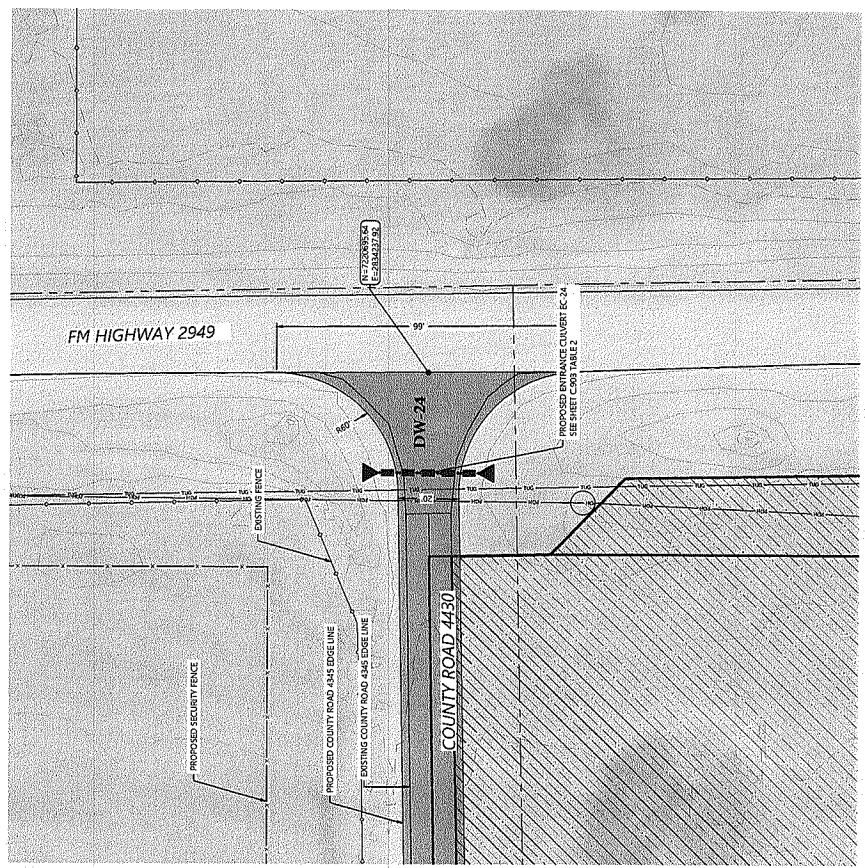

DW-24 COUNTY ROAD 4430 - FM 2949 ENTRANCE 01

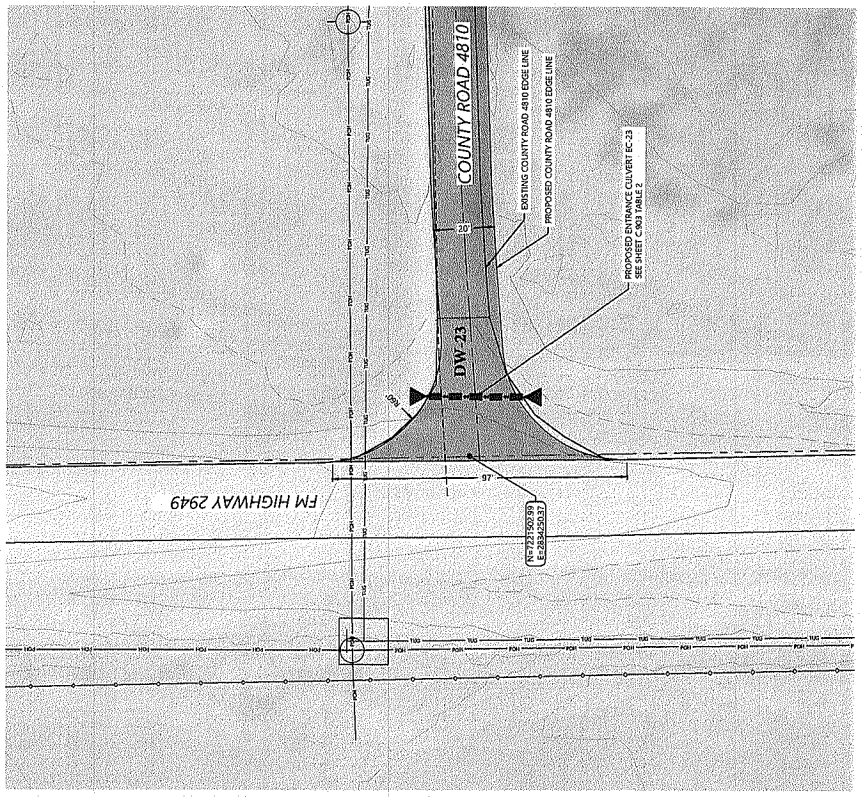

DW-23 COUNTY ROAD 4810 - FM 2949 ENTRANCE 01

LEGEND:

- PROJECT BOUNDARY
- PARCEL SECTION LINES
- PARCEL BOUNDARY
- EASEMENT LINES
- EXISTING GAS LINE
- EXISTING WATER LINE
- EXISTING POWER CONVERSION UNIT
- EXISTING OVERHEAD POWER
- EXISTING 5" INDEX CONTOUR
- PROPOSED 5" INDEX CONTOUR
- PROPOSED 1" INTERNAL CONTOUR
- PROPOSED ULS ARRAY
- PROPOSED LRA ARRAY
- PROPOSED SILT FENCE
- PROPOSED ACCESS ROAD

NOTES:

- CONTRACTOR TO INSTALL 20' IMPROVED COUNTY ROAD ROAD STRUCTURAL CROSS SECTION UP TO THE EDGE OF THE EXISTING RIGHT-OF-WAY
- SEE DETAIL C807 FOR ROCK CONSTRUCTION ENTRANCE
- SEE DETAIL C808 FOR ROADWAY ENTRANCE
- COORDINATE SYSTEMS SHALL BE AS PER STATE SPECIFICATIONS
- ENTRANCE CULVERTS ARE SIZED TO MEET THE 10-YEAR, 24-HOUR STORM EVENT PER TxDOT SPECIFICATIONS

NOTE: STRUCTURAL SECTIONS SHOW THE MINIMUM THICKNESS REQUIREMENTS DURING NORMAL FIELD CONDITIONS. THE SECTIONS MAY NEED TO BE REDESIGNED FOR ROCK CONSTRUCTION ENTRANCES. THE SECTIONS INCLUDE BUT ARE NOT LIMITED TO CONSTRUCTION DURINGS UNUSUALLY WET PERIODS OR IN LOW WIND AREAS. IF THE ROAD SURFACE IS SOFT OR MUDDY, THE SURFACE SHALL BE SCARIFIED, DRIED AND RECOMPACTED TO ACHIEVE COMPACTION. ROAD DESIGN BASED ON GEOTECHNICAL INVESTIGATION REPORT PREPARED BY KLEINFELDER DATED JANUARY 18, 2021. ROADS TO BE MAINTAINED PER THE PROCEDURES OUTLINED IN THE PROJECT GEOTECHNICAL REPORT.

NO.	DATE	COMMENT
A.	10/26/2021	10% CIVIL DESIGN SET
B.	01/29/2022	30% CIVIL DESIGN SET - 174 & 184 INCHES
C.	05/25/2022	50% CIVIL DESIGN SET - 174 & 184 INCHES
C1.	05/17/2022	50% CIVIL DESIGN SET - 187"

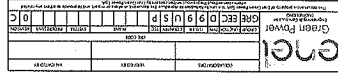

Estonian Solar Project

Delta County, Texas

Entrance Exhibits -
 County Road 4345
 Entrances

NOT FOR CONSTRUCTION

DATE 05/12/2022

SHEET: C.812

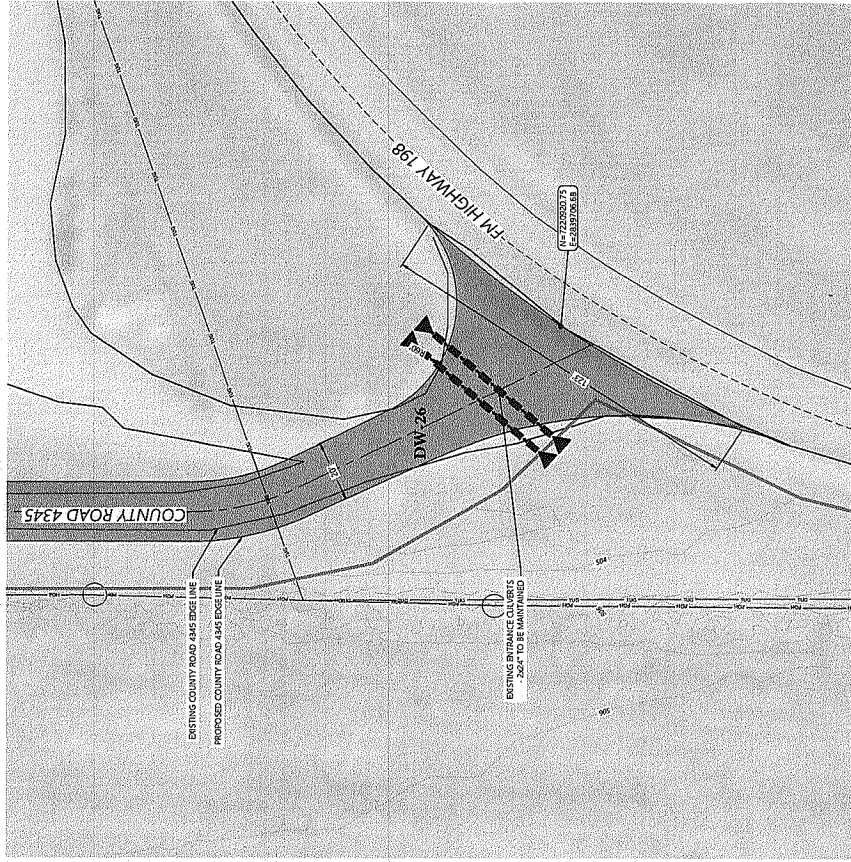

DW-26 COUNTY ROAD 4345 - FM 198 ENTRANCE 01

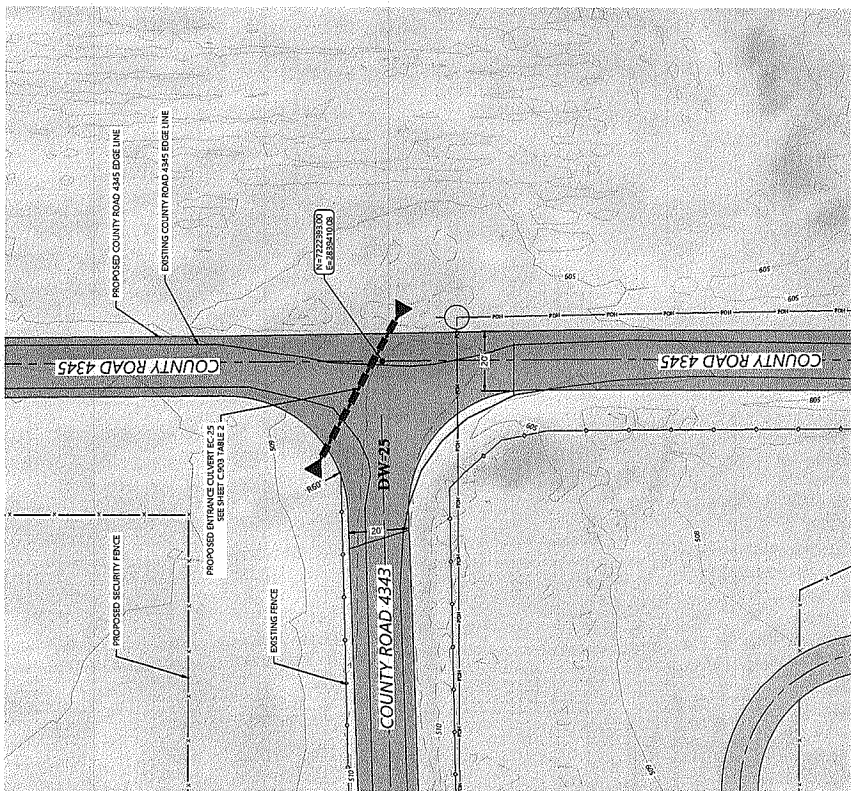

DW-25 COUNTY ROAD 4343 - COUNTY ROAD 4345 ENTRANCE 01

LEGEND:

[Symbol]	PROJECT BOUNDARY	[Symbol]	PROPOSED 10' TO 15' EASEMENT
[Symbol]	PARCEL SECTION LINES	[Symbol]	PROPOSED 15' TO 20' EASEMENT
[Symbol]	PARCEL BOUNDARY	[Symbol]	PROPOSED 20' TO 25' EASEMENT
[Symbol]	EASEMENT LINES	[Symbol]	PROPOSED 25' TO 30' EASEMENT
[Symbol]	EXISTING GAS LINE	[Symbol]	PROPOSED 30' TO 35' EASEMENT
[Symbol]	EXISTING WATER LINE	[Symbol]	PROPOSED 35' TO 40' EASEMENT
[Symbol]	EXISTING TELEPHONE LINE	[Symbol]	PROPOSED 40' TO 45' EASEMENT
[Symbol]	EXISTING OVERHEAD POWER	[Symbol]	PROPOSED 45' TO 50' EASEMENT
[Symbol]	EXISTING FENCE	[Symbol]	PROPOSED 50' TO 55' EASEMENT
[Symbol]	EXISTING US ARMY EXCLUSION AREA	[Symbol]	PROPOSED 55' TO 60' EASEMENT
[Symbol]	PROPOSED US ARMY EXCLUSION AREA	[Symbol]	PROPOSED 60' TO 65' EASEMENT
[Symbol]	PROPOSED 65' TO 70' EASEMENT	[Symbol]	PROPOSED 70' TO 75' EASEMENT
[Symbol]	PROPOSED 75' TO 80' EASEMENT	[Symbol]	PROPOSED 80' TO 85' EASEMENT
[Symbol]	PROPOSED 85' TO 90' EASEMENT	[Symbol]	PROPOSED 90' TO 95' EASEMENT
[Symbol]	PROPOSED 95' TO 100' EASEMENT	[Symbol]	PROPOSED 100' TO 105' EASEMENT
[Symbol]	PROPOSED 105' TO 110' EASEMENT	[Symbol]	PROPOSED 110' TO 115' EASEMENT
[Symbol]	PROPOSED 115' TO 120' EASEMENT	[Symbol]	PROPOSED 120' TO 125' EASEMENT
[Symbol]	PROPOSED 125' TO 130' EASEMENT	[Symbol]	PROPOSED 130' TO 135' EASEMENT
[Symbol]	PROPOSED 135' TO 140' EASEMENT	[Symbol]	PROPOSED 140' TO 145' EASEMENT
[Symbol]	PROPOSED 145' TO 150' EASEMENT	[Symbol]	PROPOSED 150' TO 155' EASEMENT
[Symbol]	PROPOSED 155' TO 160' EASEMENT	[Symbol]	PROPOSED 160' TO 165' EASEMENT
[Symbol]	PROPOSED 165' TO 170' EASEMENT	[Symbol]	PROPOSED 170' TO 175' EASEMENT
[Symbol]	PROPOSED 175' TO 180' EASEMENT	[Symbol]	PROPOSED 180' TO 185' EASEMENT
[Symbol]	PROPOSED 185' TO 190' EASEMENT	[Symbol]	PROPOSED 190' TO 195' EASEMENT
[Symbol]	PROPOSED 195' TO 200' EASEMENT	[Symbol]	PROPOSED 200' TO 205' EASEMENT
[Symbol]	PROPOSED 205' TO 210' EASEMENT	[Symbol]	PROPOSED 210' TO 215' EASEMENT
[Symbol]	PROPOSED 215' TO 220' EASEMENT	[Symbol]	PROPOSED 220' TO 225' EASEMENT
[Symbol]	PROPOSED 225' TO 230' EASEMENT	[Symbol]	PROPOSED 230' TO 235' EASEMENT
[Symbol]	PROPOSED 235' TO 240' EASEMENT	[Symbol]	PROPOSED 240' TO 245' EASEMENT
[Symbol]	PROPOSED 245' TO 250' EASEMENT	[Symbol]	PROPOSED 250' TO 255' EASEMENT
[Symbol]	PROPOSED 255' TO 260' EASEMENT	[Symbol]	PROPOSED 260' TO 265' EASEMENT
[Symbol]	PROPOSED 265' TO 270' EASEMENT	[Symbol]	PROPOSED 270' TO 275' EASEMENT
[Symbol]	PROPOSED 275' TO 280' EASEMENT	[Symbol]	PROPOSED 280' TO 285' EASEMENT
[Symbol]	PROPOSED 285' TO 290' EASEMENT	[Symbol]	PROPOSED 290' TO 295' EASEMENT
[Symbol]	PROPOSED 295' TO 300' EASEMENT	[Symbol]	PROPOSED 300' TO 305' EASEMENT
[Symbol]	PROPOSED 305' TO 310' EASEMENT	[Symbol]	PROPOSED 310' TO 315' EASEMENT
[Symbol]	PROPOSED 315' TO 320' EASEMENT	[Symbol]	PROPOSED 320' TO 325' EASEMENT
[Symbol]	PROPOSED 325' TO 330' EASEMENT	[Symbol]	PROPOSED 330' TO 335' EASEMENT
[Symbol]	PROPOSED 335' TO 340' EASEMENT	[Symbol]	PROPOSED 340' TO 345' EASEMENT
[Symbol]	PROPOSED 345' TO 350' EASEMENT	[Symbol]	PROPOSED 350' TO 355' EASEMENT
[Symbol]	PROPOSED 355' TO 360' EASEMENT	[Symbol]	PROPOSED 360' TO 365' EASEMENT
[Symbol]	PROPOSED 365' TO 370' EASEMENT	[Symbol]	PROPOSED 370' TO 375' EASEMENT
[Symbol]	PROPOSED 375' TO 380' EASEMENT	[Symbol]	PROPOSED 380' TO 385' EASEMENT
[Symbol]	PROPOSED 385' TO 390' EASEMENT	[Symbol]	PROPOSED 390' TO 395' EASEMENT
[Symbol]	PROPOSED 395' TO 400' EASEMENT	[Symbol]	PROPOSED 400' TO 405' EASEMENT
[Symbol]	PROPOSED 405' TO 410' EASEMENT	[Symbol]	PROPOSED 410' TO 415' EASEMENT
[Symbol]	PROPOSED 415' TO 420' EASEMENT	[Symbol]	PROPOSED 420' TO 425' EASEMENT
[Symbol]	PROPOSED 425' TO 430' EASEMENT	[Symbol]	PROPOSED 430' TO 435' EASEMENT
[Symbol]	PROPOSED 435' TO 440' EASEMENT	[Symbol]	PROPOSED 440' TO 445' EASEMENT
[Symbol]	PROPOSED 445' TO 450' EASEMENT	[Symbol]	PROPOSED 450' TO 455' EASEMENT
[Symbol]	PROPOSED 455' TO 460' EASEMENT	[Symbol]	PROPOSED 460' TO 465' EASEMENT
[Symbol]	PROPOSED 465' TO 470' EASEMENT	[Symbol]	PROPOSED 470' TO 475' EASEMENT
[Symbol]	PROPOSED 475' TO 480' EASEMENT	[Symbol]	PROPOSED 480' TO 485' EASEMENT
[Symbol]	PROPOSED 485' TO 490' EASEMENT	[Symbol]	PROPOSED 490' TO 495' EASEMENT
[Symbol]	PROPOSED 495' TO 500' EASEMENT	[Symbol]	PROPOSED 500' TO 505' EASEMENT
[Symbol]	PROPOSED 505' TO 510' EASEMENT	[Symbol]	PROPOSED 510' TO 515' EASEMENT
[Symbol]	PROPOSED 515' TO 520' EASEMENT	[Symbol]	PROPOSED 520' TO 525' EASEMENT
[Symbol]	PROPOSED 525' TO 530' EASEMENT	[Symbol]	PROPOSED 530' TO 535' EASEMENT
[Symbol]	PROPOSED 535' TO 540' EASEMENT	[Symbol]	PROPOSED 540' TO 545' EASEMENT
[Symbol]	PROPOSED 545' TO 550' EASEMENT	[Symbol]	PROPOSED 550' TO 555' EASEMENT
[Symbol]	PROPOSED 555' TO 560' EASEMENT	[Symbol]	PROPOSED 560' TO 565' EASEMENT
[Symbol]	PROPOSED 565' TO 570' EASEMENT	[Symbol]	PROPOSED 570' TO 575' EASEMENT
[Symbol]	PROPOSED 575' TO 580' EASEMENT	[Symbol]	PROPOSED 580' TO 585' EASEMENT
[Symbol]	PROPOSED 585' TO 590' EASEMENT	[Symbol]	PROPOSED 590' TO 595' EASEMENT
[Symbol]	PROPOSED 595' TO 600' EASEMENT	[Symbol]	PROPOSED 600' TO 605' EASEMENT
[Symbol]	PROPOSED 605' TO 610' EASEMENT	[Symbol]	PROPOSED 610' TO 615' EASEMENT
[Symbol]	PROPOSED 615' TO 620' EASEMENT	[Symbol]	PROPOSED 620' TO 625' EASEMENT
[Symbol]	PROPOSED 625' TO 630' EASEMENT	[Symbol]	PROPOSED 630' TO 635' EASEMENT
[Symbol]	PROPOSED 635' TO 640' EASEMENT	[Symbol]	PROPOSED 640' TO 645' EASEMENT
[Symbol]	PROPOSED 645' TO 650' EASEMENT	[Symbol]	PROPOSED 650' TO 655' EASEMENT
[Symbol]	PROPOSED 655' TO 660' EASEMENT	[Symbol]	PROPOSED 660' TO 665' EASEMENT
[Symbol]	PROPOSED 665' TO 670' EASEMENT	[Symbol]	PROPOSED 670' TO 675' EASEMENT
[Symbol]	PROPOSED 675' TO 680' EASEMENT	[Symbol]	PROPOSED 680' TO 685' EASEMENT
[Symbol]	PROPOSED 685' TO 690' EASEMENT	[Symbol]	PROPOSED 690' TO 695' EASEMENT
[Symbol]	PROPOSED 695' TO 700' EASEMENT	[Symbol]	PROPOSED 700' TO 705' EASEMENT
[Symbol]	PROPOSED 705' TO 710' EASEMENT	[Symbol]	PROPOSED 710' TO 715' EASEMENT
[Symbol]	PROPOSED 715' TO 720' EASEMENT	[Symbol]	PROPOSED 720' TO 725' EASEMENT
[Symbol]	PROPOSED 725' TO 730' EASEMENT	[Symbol]	PROPOSED 730' TO 735' EASEMENT
[Symbol]	PROPOSED 735' TO 740' EASEMENT	[Symbol]	PROPOSED 740' TO 745' EASEMENT
[Symbol]	PROPOSED 745' TO 750' EASEMENT	[Symbol]	PROPOSED 750' TO 755' EASEMENT
[Symbol]	PROPOSED 755' TO 760' EASEMENT	[Symbol]	PROPOSED 760' TO 765' EASEMENT
[Symbol]	PROPOSED 765' TO 770' EASEMENT	[Symbol]	PROPOSED 770' TO 775' EASEMENT
[Symbol]	PROPOSED 775' TO 780' EASEMENT	[Symbol]	PROPOSED 780' TO 785' EASEMENT
[Symbol]	PROPOSED 785' TO 790' EASEMENT	[Symbol]	PROPOSED 790' TO 795' EASEMENT
[Symbol]	PROPOSED 795' TO 800' EASEMENT	[Symbol]	PROPOSED 800' TO 805' EASEMENT
[Symbol]	PROPOSED 805' TO 810' EASEMENT	[Symbol]	PROPOSED 810' TO 815' EASEMENT
[Symbol]	PROPOSED 815' TO 820' EASEMENT	[Symbol]	PROPOSED 820' TO 825' EASEMENT
[Symbol]	PROPOSED 825' TO 830' EASEMENT	[Symbol]	PROPOSED 830' TO 835' EASEMENT
[Symbol]	PROPOSED 835' TO 840' EASEMENT	[Symbol]	PROPOSED 840' TO 845' EASEMENT
[Symbol]	PROPOSED 845' TO 850' EASEMENT	[Symbol]	PROPOSED 850' TO 855' EASEMENT
[Symbol]	PROPOSED 855' TO 860' EASEMENT	[Symbol]	PROPOSED 860' TO 865' EASEMENT
[Symbol]	PROPOSED 865' TO 870' EASEMENT	[Symbol]	PROPOSED 870' TO 875' EASEMENT
[Symbol]	PROPOSED 875' TO 880' EASEMENT	[Symbol]	PROPOSED 880' TO 885' EASEMENT
[Symbol]	PROPOSED 885' TO 890' EASEMENT	[Symbol]	PROPOSED 890' TO 895' EASEMENT
[Symbol]	PROPOSED 895' TO 900' EASEMENT	[Symbol]	PROPOSED 900' TO 905' EASEMENT
[Symbol]	PROPOSED 905' TO 910' EASEMENT	[Symbol]	PROPOSED 910' TO 915' EASEMENT
[Symbol]	PROPOSED 915' TO 920' EASEMENT	[Symbol]	PROPOSED 920' TO 925' EASEMENT
[Symbol]	PROPOSED 925' TO 930' EASEMENT	[Symbol]	PROPOSED 930' TO 935' EASEMENT
[Symbol]	PROPOSED 935' TO 940' EASEMENT	[Symbol]	PROPOSED 940' TO 945' EASEMENT
[Symbol]	PROPOSED 945' TO 950' EASEMENT	[Symbol]	PROPOSED 950' TO 955' EASEMENT
[Symbol]	PROPOSED 955' TO 960' EASEMENT	[Symbol]	PROPOSED 960' TO 965' EASEMENT
[Symbol]	PROPOSED 965' TO 970' EASEMENT	[Symbol]	PROPOSED 970' TO 975' EASEMENT
[Symbol]	PROPOSED 975' TO 980' EASEMENT	[Symbol]	PROPOSED 980' TO 985' EASEMENT
[Symbol]	PROPOSED 985' TO 990' EASEMENT	[Symbol]	PROPOSED 990' TO 995' EASEMENT
[Symbol]	PROPOSED 995' TO 1000' EASEMENT	[Symbol]	PROPOSED 1000' TO 1005' EASEMENT

NOTES:

- CONTRACTOR TO INSTALL 20" IMPROVED COUNTY ROAD STRUCTURAL CROSS SECTION UP TO THE EDGE OF THE EXISTING RIGHT OF WAY
- SEE DETAIL C 807 FOR ROCK CONSTRUCTION IN RAINAGE
- CONTRACTOR TO MAINTAIN 10' TO 15' WIDE STORM DRAINAGE CHANNELS THROUGHOUT THE PROJECT
- COORDINATE SYSTEM IS NAD83, TEXAS STATE PLANE, CENTRAL ZONE, US FOOT
- ENTRANCE CHAIRS ARE SIZED TO MEET THE 10-YEAR, 24-HOUR STORM EVENT PER TxDOT SPECIFICATIONS

NOTE:

- STRUCTURAL SECTIONS SHOWN ARE THE MINIMUM THICKNESS REQUIREMENTS DURING NORMAL FIELD CONDITIONS. THE SECTIONS MAY NEED TO BE THICKENED TO ACCOMMODATE EXCESSIVE TRAFFIC LOADS OR UNUSUAL WEATHER CONDITIONS. CONDITIONS INCLUDE BUT ARE NOT LIMITED TO CONSTRUCTION DURING UNUSUALLY WET PERIODS, OR IN LOWWATER AREAS.
- CONTRACTOR TO MAINTAIN 10' TO 15' WIDE STORM DRAINAGE CHANNELS THROUGHOUT THE PROJECT.
- ROAD DESIGN BASED ON GEOLOGICAL INVESTIGATION REPORT PREPARED BY KLENFELDER DATED JANUARY 18, 2021.
- ROADS TO BE MAINTAINED PER THE PROCEDURES OUTLINED IN THE PROJECT GEOLOGICAL REPORT.

20" IMPROVED COUNTY ROAD CROSS SECTION

6" GRADED GRAVEL BASE

8" LIME STABILIZED SUBGRADE

20" IMPROVED COUNTY ROAD CROSS SECTION

NOTE:
 TEMPORARY INUNDATION BOUNDARY SHOWN FROM
 TEMPORARY SEDIMENT CONTROL BERM DURING THE 2-YEAR
 24-HOUR STORM EVENT - AVOID STORAGE IN THESE AREAS

NO.	DATE	COMMENTS
A	10/26/2021	FOR GROUND DESIGN SET
B	03/09/2022	FOR CIVIL DESIGN SET - 10% & 15% MOISTURES
C	05/02/2022	FOR CIVIL DESIGN SET - 10% & 15% MOISTURES
D	05/12/2022	FOR CIVIL DESIGN SET - 10% & 15% MOISTURES

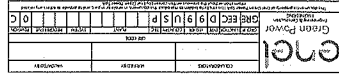

Estonian Solar Project

Delta County, Texas

Civil Site Details

NOT FOR CONSTRUCTION

DATE 05/12/2022

SHEET: C.900

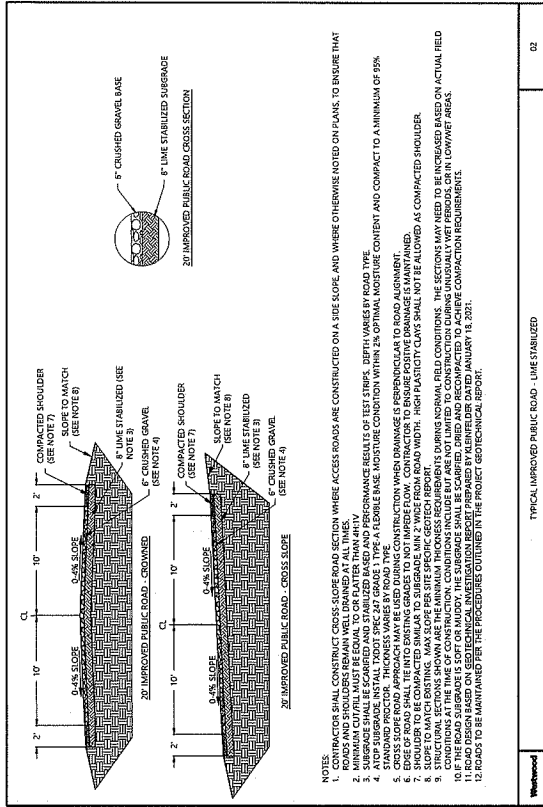
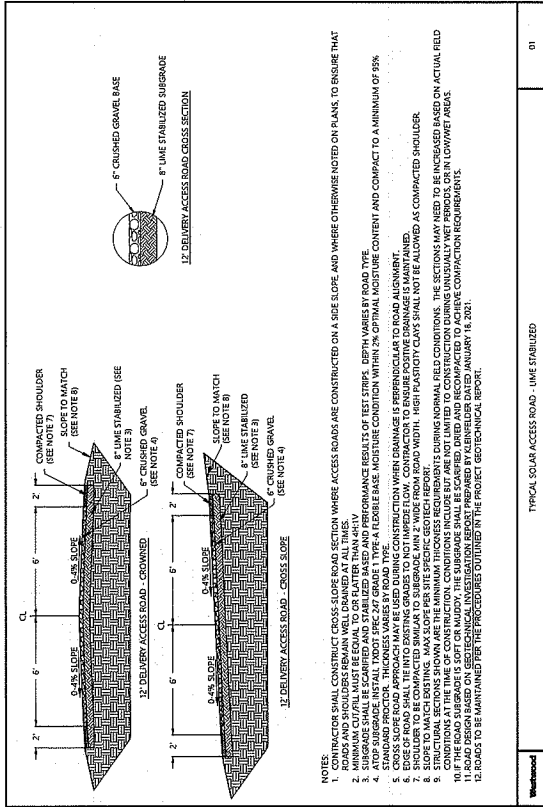

NO.	DATE	COMMENT
A.	05/12/2022	ISSUE FOR CONSTRUCTION
B.	05/12/2022	ISSUE FOR CONSTRUCTION
C.	05/12/2022	ISSUE FOR CONSTRUCTION
D.	05/12/2022	ISSUE FOR CONSTRUCTION

NO.	DATE	COMMENT
A.	05/12/2022	ISSUE FOR CONSTRUCTION
B.	05/12/2022	ISSUE FOR CONSTRUCTION
C.	05/12/2022	ISSUE FOR CONSTRUCTION
D.	05/12/2022	ISSUE FOR CONSTRUCTION

Estonian Solar Project
 Delta County, Texas

Civil Site Details
 NOT FOR CONSTRUCTION
 DATE 05/12/2022
 SHEET C.901

TABLE 1. DRAINAGE CROSSING TABLE

Crossing ID	10 Year Peak Flow (cfs)		2 Year Peak Flow (cfs)		10 Year Peak Flow (cfs)		2 Year Peak Flow (cfs)		10 Year Low Water Crossing
	10 Year Peak Flow (cfs)	2 Year Peak Flow (cfs)	10 Year Peak Flow (cfs)	2 Year Peak Flow (cfs)	10 Year Peak Flow (cfs)	2 Year Peak Flow (cfs)	10 Year Peak Flow (cfs)	2 Year Peak Flow (cfs)	
DC-01	141.5	66.0	141.5	66.0	141.5	66.0	141.5	66.0	STANDARD DUTY
DC-02	141.5	66.0	141.5	66.0	141.5	66.0	141.5	66.0	STANDARD DUTY
DC-03	128.2	59.7	128.2	59.7	128.2	59.7	128.2	59.7	HEAVY DUTY
DC-04	64.6	30.4	64.6	30.4	64.6	30.4	64.6	30.4	STANDARD DUTY
DC-05	20.7	10.1	20.7	10.1	20.7	10.1	20.7	10.1	STANDARD DUTY
DC-06	20.7	10.1	20.7	10.1	20.7	10.1	20.7	10.1	HEAVY DUTY
DC-07	20.7	10.1	20.7	10.1	20.7	10.1	20.7	10.1	HEAVY DUTY
DC-08	20.7	10.1	20.7	10.1	20.7	10.1	20.7	10.1	HEAVY DUTY
DC-09	20.7	10.1	20.7	10.1	20.7	10.1	20.7	10.1	HEAVY DUTY
DC-10	20.7	10.1	20.7	10.1	20.7	10.1	20.7	10.1	HEAVY DUTY
DC-11	20.7	10.1	20.7	10.1	20.7	10.1	20.7	10.1	HEAVY DUTY
DC-12	20.7	10.1	20.7	10.1	20.7	10.1	20.7	10.1	HEAVY DUTY
DC-13	20.7	10.1	20.7	10.1	20.7	10.1	20.7	10.1	HEAVY DUTY
DC-14	20.7	10.1	20.7	10.1	20.7	10.1	20.7	10.1	HEAVY DUTY
DC-15	20.7	10.1	20.7	10.1	20.7	10.1	20.7	10.1	HEAVY DUTY
DC-16	20.7	10.1	20.7	10.1	20.7	10.1	20.7	10.1	HEAVY DUTY
DC-17	20.7	10.1	20.7	10.1	20.7	10.1	20.7	10.1	HEAVY DUTY
DC-18	20.7	10.1	20.7	10.1	20.7	10.1	20.7	10.1	HEAVY DUTY
DC-19	20.7	10.1	20.7	10.1	20.7	10.1	20.7	10.1	HEAVY DUTY
DC-20	20.7	10.1	20.7	10.1	20.7	10.1	20.7	10.1	HEAVY DUTY
DC-21	20.7	10.1	20.7	10.1	20.7	10.1	20.7	10.1	HEAVY DUTY
DC-22	20.7	10.1	20.7	10.1	20.7	10.1	20.7	10.1	HEAVY DUTY
DC-23	20.7	10.1	20.7	10.1	20.7	10.1	20.7	10.1	HEAVY DUTY
DC-24	20.7	10.1	20.7	10.1	20.7	10.1	20.7	10.1	HEAVY DUTY
DC-25	20.7	10.1	20.7	10.1	20.7	10.1	20.7	10.1	HEAVY DUTY
DC-26	20.7	10.1	20.7	10.1	20.7	10.1	20.7	10.1	HEAVY DUTY
DC-27	20.7	10.1	20.7	10.1	20.7	10.1	20.7	10.1	HEAVY DUTY
DC-28	20.7	10.1	20.7	10.1	20.7	10.1	20.7	10.1	HEAVY DUTY
DC-29	20.7	10.1	20.7	10.1	20.7	10.1	20.7	10.1	HEAVY DUTY
DC-30	20.7	10.1	20.7	10.1	20.7	10.1	20.7	10.1	HEAVY DUTY
DC-31	20.7	10.1	20.7	10.1	20.7	10.1	20.7	10.1	HEAVY DUTY

NOTE: UNPAVED DRAINAGE CROSSINGS ARE SHOWN ON THE CONSTRUCTION PLANS BASED LARGELY ON OBSERVATION OF DRAINAGE CHANGE EROSION FROM AERIAL PHOTOGRAPHY. SUPPLEMENTED BY 6S STREAM NETWORK AND EXISTING CONTOUR DATA AVAILABLE. ADDITIONAL CROSSINGS (LOW WATER CROSSINGS/CULVERTS) MAY NEED TO BE INSTALLED IN AREAS WHERE CONCENTRATED FLOW IS EXPECTED DUE TO CONSTRUCTION ACTIVITIES. CONTRACTOR SHALL USE DISCRETION AS TO WHETHER A LOW WATER CROSSING OR CULVERT IS NEEDED BASED ON THE TOPOGRAPHY OF THE DRAINAGE CROSSING. IF CULVERTS ARE SELECTED, CONTRACTOR SHALL FIELD FIT A CULVERT BASED ON ENGINEER GUIDANCE.

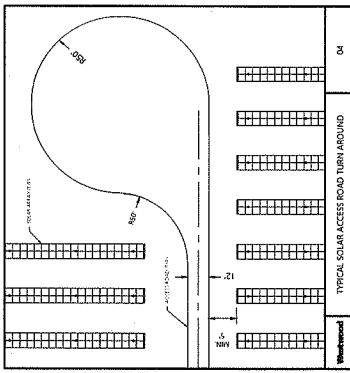
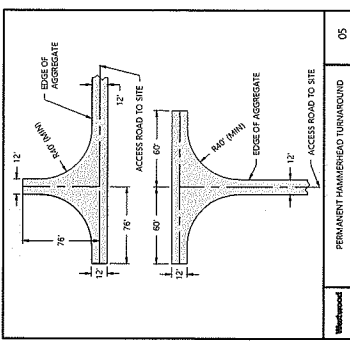

Westwood 04 PERMANENT HAMMERHEAD TURN AROUND 05

Westwood 04 TYPICAL SOLAR ACCESS ROAD TURN AROUND 05

NO.	DATE	COMMENT
A.	05/12/2022	REV. DATE DESIGN SET - 10# & 15# NOODLES
B.	05/12/2022	REV. DATE DESIGN SET - 10# & 15# NOODLES
C.	05/12/2022	REV. DATE DESIGN SET - 10# & 15# NOODLES
C1.	05/12/2022	REV. DATE DESIGN SET - 10#

DESIGNED BY	DATE	SCALE
CHECKED BY	DATE	SCALE
APPROVED BY	DATE	SCALE

Estonian Solar Project
 Delta County, Texas

TxDOT Entrance Details
 NOT FOR CONSTRUCTION
 DATE 05/12/2022
 SHEET C.906

FOR TxDOT ROW ONLY

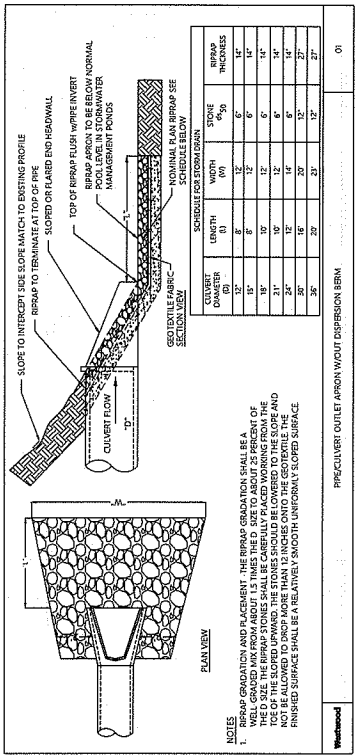

FOR TxDOT ROW ONLY

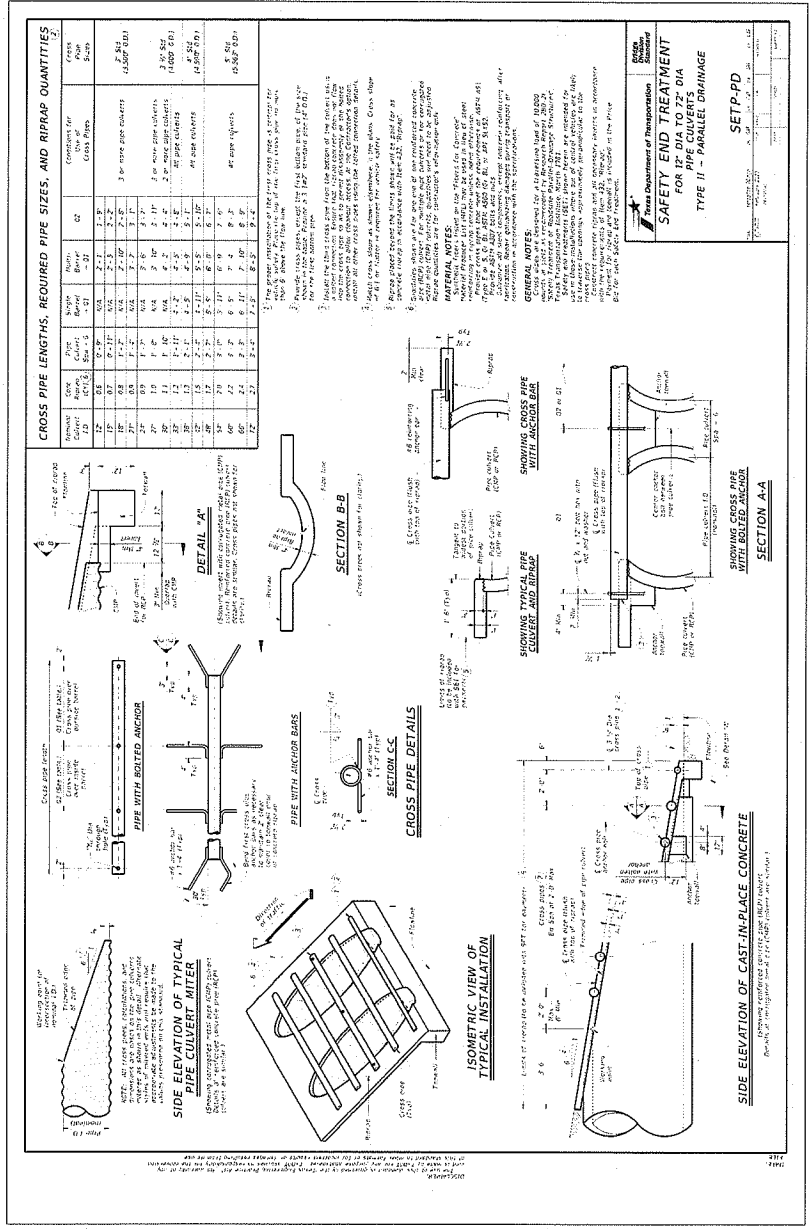

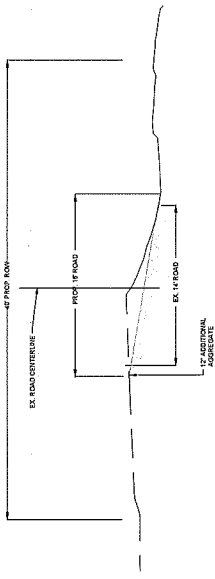

EXISTING VS PROPOSED ROAD CROSS SECTION (NTS)

- NOTES**
- CROSS SECTION WILL VARY BY LOCATION IN FIELD.
 - EXISTING DIMENSIONS TO MAINTAIN ORIGINAL ELEVATION AND GRADE.
 - WITHIN THE WIDTH OF WAY REMOVED DURING IMPROVEMENT TO BE REPLACED IF REQUIRED.
 - CENTRELINE (NOT TOTAL) SHOWN AS 22' FROM PROPERTY.

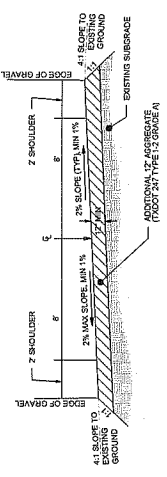

- NOTES**
- 4:1 MAXIMUM SLOPE FROM EDGE OF GRAVEL TO EXISTING GROUND.
 - AGGREGATE BASE COMPACTED TO A MINIMUM OF 90% OF THE MODIFIED PROCTOR.
 - ROAD GRADES ARE TYPICALLY INTENDED TO MATCH ADJACENT GRADE ALLOWING FOR MINOR ADJUSTMENTS TO MAINTAIN PROPER DRAINAGE PATTERNES OR MATCH LOCALS AND ADJACENT TO PREVENT UNDESIRABLE DRAINAGE CONDITIONS ALONG ROAD EDGES CAUSING EROSION.
 - MAINTAIN MINIMUM DEPTH ROADS SHALL UNDERGO SEMI-ANNUAL MAINTENANCE.

1 16' ROADWAY WITH 2' SHOULDER

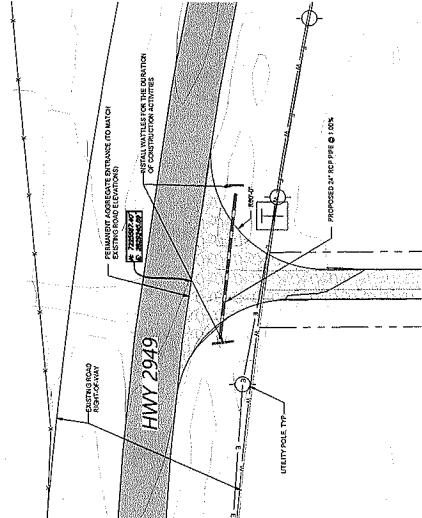
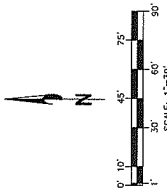

TXDOT ACCESS DETAIL

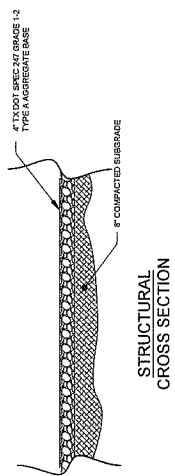

STRUCTURAL CROSS SECTION

- DETAIL NOTES**
- STRUCTURAL SECTIONS SHOWN ARE THE MINIMUM THICKNESS REQUIREMENTS DURING NORMAL FIELD CONSTRUCTION. CONDITIONS INCLUDE BUT ARE NOT LIMITED TO CONSTRUCTION DURING UNUSUALLY WET WEATHER CONDITIONS. ALL STRUCTURES SHALL BE CONSTRUCTED TO MEET THE DESIGN AND CONSTRUCTION REQUIREMENTS OF THE TEXAS STANDARD SPECIFICATIONS 207 TYPE A GRADE 1-2.
 - ROAD BASE SHALL BE TESTED BY A LICENSED ENGINEER OR BY HIS/HER DECISION. TESTING REQUIREMENTS TO BE DONE IN CONFORMANCE WITH TXDOT STANDARD SPECIFICATIONS.

**FOR PERMIT
SUBMITTAL**
PENDING GOVERNING
AUTHORITY APPROVAL

NO.	DATE	DESCRIPTION	ISSUED FOR COUNTY REVIEW	DATE	BY
0	05/17/22	ISSUED FOR COUNTY REVIEW	05/17/22	05/17/22	ESB
1	05/17/22	ISSUED FOR COUNTY REVIEW	05/17/22	05/17/22	ESB
2	05/17/22	ISSUED FOR COUNTY REVIEW	05/17/22	05/17/22	ESB

PROJECT:		ESTONIAN SOLAR	
OWNER:	DELTA COUNTY, TEXAS	PROJECT NO.:	CR 4825 ROADWAY IMPROVEMENTS
DESIGNER:	CR 4825 ROADWAY IMPROVEMENTS	FLAT SCALE:	213
TITLE:	COUNTY ROAD 4825 ROADWAY IMPROVEMENTS (2 OF 3)	SHEET:	213

DATE	BY	DATE	BY	DATE	BY
05/17/22	ESB	05/17/22	ESB	05/17/22	ESB

nei
ELECTRIC POWER ENGINEERING, INC.
TEXAS REGISTERED ENGINEERING FIRM
F-17716

FOR NEI ELECTRIC POWER ENGINEERING, INC.
TEXAS REGISTERED ENGINEERING FIRM
F-17716

CROSS PIPE LENGTHS, REQUIRED PIPE SIZES, & RIPRAP QUANTITIES

Vertical Riprap Culvert (1.0' Dia)	Horizontal Riprap Culvert (1.0' Dia)	Concrete Pipe Size	Riprap Quantity (cu yd)
15'	15'	36" Std. C.P.	3 or more Pipe Culverts (3,500' O.D.)
18'	18'	42" Std. C.P.	3 or more Pipe Culverts (4,000' O.D.)
21'	21'	48" Std. C.P.	3 or more Pipe Culverts (4,500' O.D.)
24'	24'	54" Std. C.P.	3 or more Pipe Culverts (5,000' O.D.)
27'	27'	60" Std. C.P.	3 or more Pipe Culverts (5,500' O.D.)
30'	30'	66" Std. C.P.	3 or more Pipe Culverts (6,000' O.D.)
33'	33'	72" Std. C.P.	3 or more Pipe Culverts (6,500' O.D.)
36'	36'	78" Std. C.P.	3 or more Pipe Culverts (7,000' O.D.)
39'	39'	84" Std. C.P.	3 or more Pipe Culverts (7,500' O.D.)
42'	42'	90" Std. C.P.	3 or more Pipe Culverts (8,000' O.D.)
45'	45'	96" Std. C.P.	3 or more Pipe Culverts (8,500' O.D.)
48'	48'	102" Std. C.P.	3 or more Pipe Culverts (9,000' O.D.)
51'	51'	108" Std. C.P.	3 or more Pipe Culverts (9,500' O.D.)
54'	54'	114" Std. C.P.	3 or more Pipe Culverts (10,000' O.D.)
57'	57'	120" Std. C.P.	3 or more Pipe Culverts (10,500' O.D.)
60'	60'	126" Std. C.P.	3 or more Pipe Culverts (11,000' O.D.)
63'	63'	132" Std. C.P.	3 or more Pipe Culverts (11,500' O.D.)
66'	66'	138" Std. C.P.	3 or more Pipe Culverts (12,000' O.D.)
69'	69'	144" Std. C.P.	3 or more Pipe Culverts (12,500' O.D.)
72'	72'	150" Std. C.P.	3 or more Pipe Culverts (13,000' O.D.)

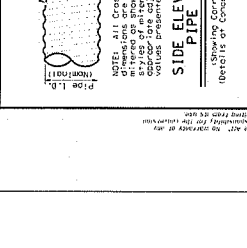
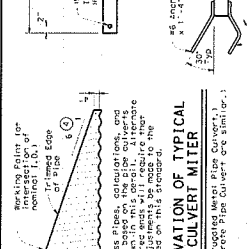
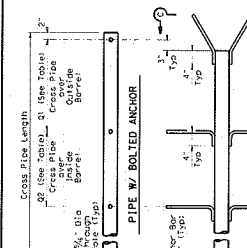
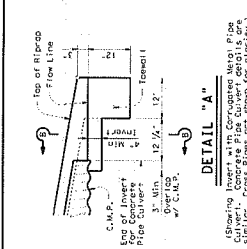

GENERAL NOTES:

1. Riprap shall be placed in accordance with the specifications for riprap in the contract documents.
2. Riprap shall be placed in accordance with the specifications for riprap in the contract documents.
3. Riprap shall be placed in accordance with the specifications for riprap in the contract documents.
4. Riprap shall be placed in accordance with the specifications for riprap in the contract documents.
5. Riprap shall be placed in accordance with the specifications for riprap in the contract documents.
6. Riprap shall be placed in accordance with the specifications for riprap in the contract documents.
7. Riprap shall be placed in accordance with the specifications for riprap in the contract documents.
8. Riprap shall be placed in accordance with the specifications for riprap in the contract documents.
9. Riprap shall be placed in accordance with the specifications for riprap in the contract documents.
10. Riprap shall be placed in accordance with the specifications for riprap in the contract documents.

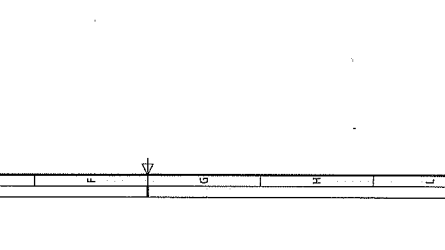
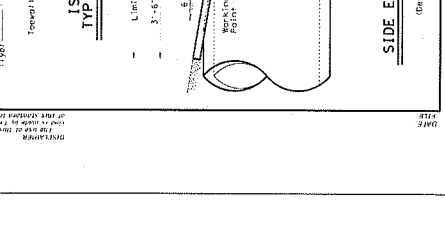
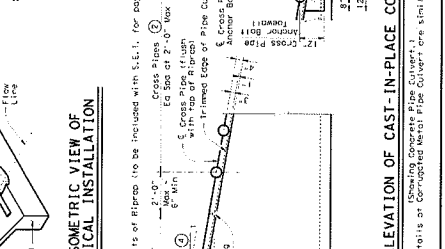
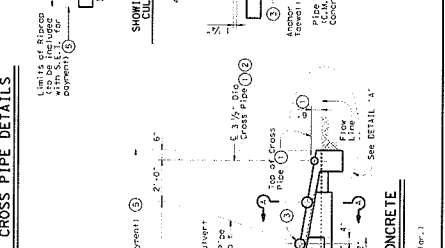
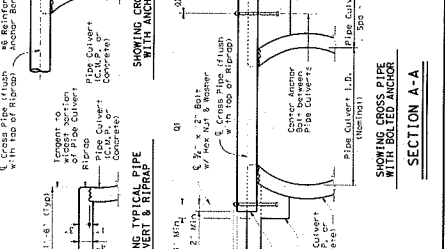
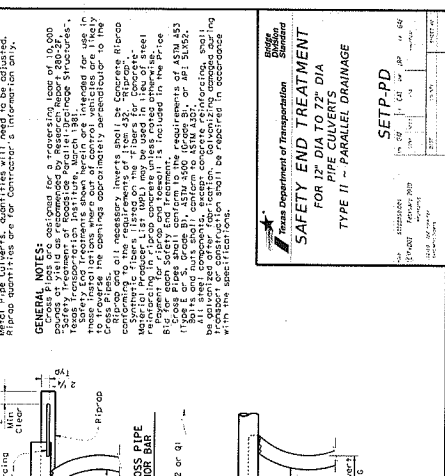
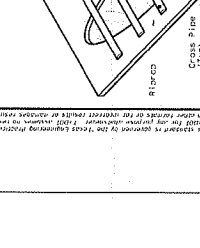
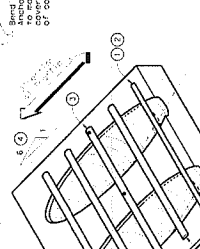
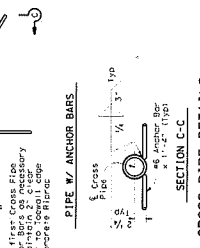
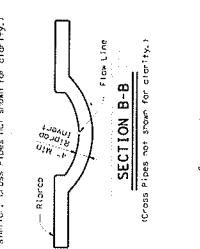

GENERAL NOTES:

1. Riprap shall be placed in accordance with the specifications for riprap in the contract documents.
2. Riprap shall be placed in accordance with the specifications for riprap in the contract documents.
3. Riprap shall be placed in accordance with the specifications for riprap in the contract documents.
4. Riprap shall be placed in accordance with the specifications for riprap in the contract documents.
5. Riprap shall be placed in accordance with the specifications for riprap in the contract documents.
6. Riprap shall be placed in accordance with the specifications for riprap in the contract documents.
7. Riprap shall be placed in accordance with the specifications for riprap in the contract documents.
8. Riprap shall be placed in accordance with the specifications for riprap in the contract documents.
9. Riprap shall be placed in accordance with the specifications for riprap in the contract documents.
10. Riprap shall be placed in accordance with the specifications for riprap in the contract documents.

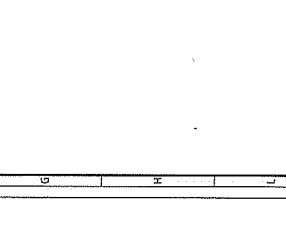
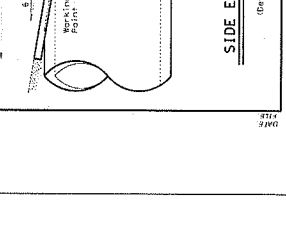
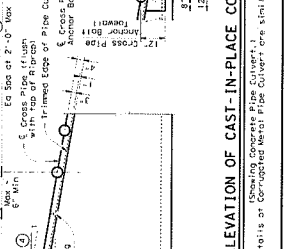
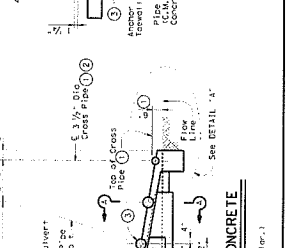
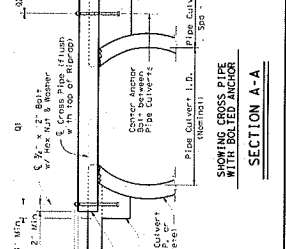

SAFETY END TREATMENT FOR PIPE CULVERTS TYPE II - PARALLEL DRAINAGE

SET-PD

ISSUED FOR COUNTY REVIEW

PROJECT: ESTONIAN SOLAR SUBSTATION

CLIENT: DELTA COUNTY, TEXAS

CLASSIFICATION: CR 4826 ROADWAY IMPROVEMENTS

TITLE: COUNTY ROAD 4826 ROADWAY IMPROVEMENTS (3 OF 3)

DATE: 12/15/18

PROJECT NO: 18130004010

DESIGNER: GREEED

CONTRACTOR: CR 4826 ROADWAY IMPROVEMENTS

SCALE: AS SHOWN

DATE: 12/15/18

PROJECT NO: 18130004010

DESIGNER: GREEED

CONTRACTOR: CR 4826 ROADWAY IMPROVEMENTS

SCALE: AS SHOWN

DATE: 12/15/18

FOR PERMIT SUBMITTAL

PENDING GOVERNING AUTHORITY APPROVAL

MEI

MEI ELECTRIC POWER ENGINEERING, INC.

15400 WESTSHORE BLVD.

LAKEWOOD, CO 80115

TEL: 303-451-2872

WWW.MEIENGINEERING.COM

FOR PERMIT SUBMITTAL

PENDING GOVERNING AUTHORITY APPROVAL

MEI

MEI ELECTRIC POWER ENGINEERING, INC.

15400 WESTSHORE BLVD.

LAKEWOOD, CO 80115

TEL: 303-451-2872

WWW.MEIENGINEERING.COM

Fund Name ----- Difference -----

TOTAL NON-DEPARTMENTAL	.00
TOTAL EXP	.00
TOTAL EXP -	.00
TOTAL EXPENSES	.00
TOTAL EXPENSES	.00

JASON MURRAY	_____
MORGAN BAKER	_____
JIMMY SWEAT	_____
ANTHONY ROBERTS	_____
MARK BRANTLEY	_____
DEBBIE HUIE	_____

THIS LIST WAS REVIEWED AND APPROVED.

From Amount	G/L Code	Account Name	To Amount
21,297.20	010-409-202	EMPLOYEE HEALTH INSURANCE	
	010-409-560	CONTINGENCY	21,297.20
1,362.44	021-621-202	HEALTH INSURANCE	
	021-621-490	MISC	1,362.44
1,362.44	022-622-202	HEALTH INSURANCE	
	022-622-490	MISC	1,362.44
1,362.44	023-623-202	HEALTH INSURANCE	
	023-623-490	MISC	1,362.44
1,362.45	024-624-202	HEALTH INSURANCE	
	024-624-490	MISC	1,362.45
=====			=====
26,746.97			26,746.97

Year	GL Account	Name	Date	Original Amount	New Amount	Difference	Clerk
2022	010-409-202	EMPLOYEE HEALTH INSURANCE	05/20/2022	38,693.57	17,396.37	21,297.20-	D
2022	010-409-560	CONTINGENCY	05/20/2022	25,399.59	46,696.79	21,297.20	D
	TOTAL NON-DEPARTMENTAL			Total Transfers	Total Changes	.00	
2022	021-621-202	HEALTH INSURANCE	05/20/2022	7,500.00	6,137.56	1,362.44-	D
2022	021-621-490	MISC	05/20/2022	162.00	1,524.44	1,362.44-	D
	TOTAL EXP			Total Transfers	Total Changes	.00	
2022	022-622-202	HEALTH INSURANCE	05/20/2022	7,500.00	6,137.56	1,362.44-	D
2022	022-622-490	MISC	05/20/2022	1,000.00	2,362.44	1,362.44-	D
	TOTAL EXP			Total Transfers	Total Changes	.00	
2022	023-623-202	HEALTH INSURANCE	05/20/2022	7,500.00	6,137.56	1,362.44-	D
2022	023-623-490	MISC	05/20/2022	1,000.00	2,362.44	1,362.44-	D
	TOTAL EXPENSES			Total Transfers	Total Changes	.00	
2022	024-624-202	HEALTH INSURANCE	05/20/2022	7,500.00	6,137.55	1,362.45-	D
2022	024-624-490	MISC	05/20/2022	100.00	1,462.45	1,362.45-	D
	TOTAL EXPENSES			Total Transfers	Total Changes	.00	

From Amount	G/L Code	Account Name	To Amount
21,297.20	010-409-202	EMPLOYEE HEALTH INSURANCE	
	010-409-560	CONTINGENCY	21,297.20
1,362.44	021-621-202	HEALTH INSURANCE	
	021-621-490	MISC	1,362.44
1,362.44	022-622-202	HEALTH INSURANCE	
	022-622-490	MISC	1,362.44
1,362.44	023-623-202	HEALTH INSURANCE	
	023-623-490	MISC	1,362.44
1,362.45	024-624-202	HEALTH INSURANCE	
	024-624-490	MISC	1,362.45
===== 26,746.97			===== 26,746.97

ACCOUNT NO	ACCOUNT NAME	ENCUMBRANCE	BUDGET	** ACTUAL ** M-T-D	*** ACTUAL *** Y-T-D	**** PERCENT	**** ACTUAL **** REMAINING	***** PERCENT
2022 010-409-000	NON-DEPARTMENTAL	.00	.00	.00	.00	.00	17,396.37	100.00
2022 010-409-202	EMPLOYEE HEALTH INSURANCE	.00	17,396.37	.00	.00	.00	17,396.37	100.00
2022 010-409-204	WORKMAN COMP	.00	1,784.00	.00	.00	.00	1,784.00	100.00
2022 010-409-310	COUNTY OFFICE SUPPLIES	.00	6,500.00	1,524.82	6,298.99	96.91	201.01	3.09
2022 010-409-311	POSTAGE	.00	7,000.00	73.68	5,311.92	75.88	1,688.08	24.12
2022 010-409-312	POSTAGE METER RENT	.00	2,856.66	.00	1,190.25	41.67	1,666.41	58.33
2022 010-409-400	MURDER TRIAL	.00	.00	.00	.00	.00	.00	.00
2022 010-409-401	OTHER GOVERNMENTS	.00	133,604.00	.00	68,383.34	51.18	65,220.66	48.82
2022 010-409-402	I TICKET	.00	.00	.00	.00	.00	.00	.00
2022 010-409-403	OUTSIDE COUNTY AUDIT	.00	13,000.00	.00	.00	.00	13,000.00	100.00
2022 010-409-404	PC 30	.00	.00	.00	.00	.00	.00	.00
2022 010-409-408	CRIMES SOFTWARE	.00	26,000.00	.00	18,750.00	72.12	7,250.00	27.88
2022 010-409-420	TELEPHONE	.00	11,044.85	912.61	7,299.86	66.09	3,745.00	33.91
2022 010-409-421	TELEPHONE MAINTENANCE	.00	.00	.00	.00	.00	.00	.00
2022 010-409-430	PUBLIC NOTICE	.00	1,255.50	.00	1,020.50	81.28	235.00	18.72
2022 010-409-451	ELEVATOR MAINTENANCE	.00	2,835.95	.00	2,535.22	89.40	300.73	10.60
2022 010-409-452	COMPUTER MAINTENANCE	.00	12,000.00	1,200.00	7,646.14	63.72	4,353.86	36.28
2022 010-409-453	COPY MACHINE	.00	3,000.00	232.38	2,298.76	76.63	701.24	23.37
2022 010-409-481	AIRMED CARE DUES	.00	.00	.00	.00	.00	.00	.00
2022 010-409-482	INSURANCE	.00	29,500.00	.00	30,064.00	101.91	564.00	1.91
2022 010-409-490	MISCELLANEOUS	.00	10,250.00	195.30	10,259.46	100.09	9.46	0.09
2022 010-409-491	ECONOMIC DEVELOPMENT	.00	.00	.00	.00	.00	.00	.00
2022 010-409-550	GRANTS	.00	57,200.00	.00	.00	.00	57,200.00	100.00
2022 010-409-560	CONTINGENCY	.00	46,696.79	.00	25,399.59	54.39	21,297.20	45.61
2022 010-409-580	HOMELAND SECURITY GRANT	.00	.00	.00	.00	.00	.00	.00
2022 010-409-581	RIGHT OF WAY	.00	.00	.00	.00	.00	.00	.00
2022 010-409-610	DEBT SERVICE	.00	.00	.00	.00	.00	.00	.00
2022 010-409-650	INTEREST EXPENSE	.00	.00	.00	.00	.00	.00	.00
2022 010-409-700	TRANSFER FUNDS	.00	381,924.13	20,854.79	186,458.03	48.82	195,466.10	51.18
2022 010-409-700	TOTAL NON-DEPARTMENTAL	.00	381,924.13	20,854.79	186,458.03	48.82	195,466.10	51.18
	FINAL TOTAL	.00	381,924.13	20,854.79	186,458.03	48.82	195,466.10	51.18

64.51% OF YEAR COMPLETED ROAD & BRIDGE PCT#1

ACCOUNT NO	ACCOUNT NAME	ENCUMBRANCE	BUDGET	** ACTUAL ** M-T-D	*** ACTUAL *** Y-T-D	**** ACTUAL **** PERCENT	***** ACTUAL ***** REMAINING PERCENT
2022 021-621-000	ROAD & BRIDGE 1	.00	.00	.00	.00	.00	.00
2022 021-621-101	COMMISSIONER'S SALARY	.00	45,000.00	3,461.54	29,423.09	65.38	15,576.91
2022 021-621-106	ROAD WORKER SALARIES	.00	29,898.45	2,299.88	19,548.98	65.38	10,349.47
2022 021-621-107	PAY FOR PERFORMANCE	.00	.00	.00	.00	.00	.00
2022 021-621-108	OVERTIME FOREMAN	.00	.00	.00	.00	.00	.00
2022 021-621-150	LONGEVITY PAY	.00	36,395.06	2,799.62	23,796.77	65.38	12,598.29
2022 021-621-201	PAYROLL TAXES	.00	8,513.95	685.54	5,811.79	68.26	2,702.16
2022 021-621-202	HEALTH INSURANCE	.00	6,137.56	.00	.00	.00	6,137.56
2022 021-621-203	RETIREMENT	.00	7,423.28	597.70	5,067.11	68.26	2,356.17
2022 021-621-204	WORKMAN COMP	.00	1,781.20	.00	498.88	28.01	1,282.32
2022 021-621-205	UNIFORMS/PROTECTIVE EQUIPMEN	.00	1,000.00	.00	.00	.00	1,000.00
2022 021-621-206	UNEMPLOYMENT	.00	33.15	.00	16.57	49.98	16.58
2022 021-621-207	DEATH BENEFIT	.00	623.24	48.40	417.36	66.97	205.88
2022 021-621-225	FUEL ALLOWANCE	.00	4,800.00	400.00	3,200.00	66.67	1,600.00
2022 021-621-310	SHOP SUPPLIES	.00	1,000.00	34.70	139.12	13.91	860.88
2022 021-621-330	GAS & OIL	.00	12,500.00	177.09	9,279.07	74.23	3,220.93
2022 021-621-340	ROAD OIL & ROCK	.00	35,000.00	.00	3,211.72	9.18	31,788.28
2022 021-621-341	MATERIAL	.00	2,500.00	.00	.00	.00	2,500.00
2022 021-621-342	TIN HORNS	.00	3,500.00	.00	358.20	10.23	3,141.80
2022 021-621-343	CHEMICALS	.00	500.00	.00	4.10	0.82	495.90
2022 021-621-352	REPAIRS	.00	10,000.00	216.10	4,100.64	41.01	5,899.36
2022 021-621-353	TOOLS	.00	1,500.00	.00	35.68	2.38	1,464.32
2022 021-621-400	ATTORNEY FEES	.00	1,400.00	.00	428.23	30.59	971.77
2022 021-621-401	CENTRAL APPRAISAL DISTRICT	.00	.00	.00	.00	.00	.00
2022 021-621-406	DELTA COUNTY APPRAISAL DIST.	.00	6,217.00	1,554.38	4,663.14	75.01	1,553.86
2022 021-621-413	OTHER GOVERNMENTS	.00	500.00	.00	288.00	57.60	212.00
2022 021-621-420	TELEPHONE	.00	850.00	.00	550.16	64.72	299.84
2022 021-621-421	CELL PHONE	.00	250.00	.00	250.00	100.00	.00
2022 021-621-427	EDUCATION/TRAVEL	.00	2,500.00	.00	710.65	28.43	1,789.35
2022 021-621-440	ELECTRICITY	.00	750.00	39.96	661.87	88.25	88.13
2022 021-621-441	GAS	.00	250.00	.00	.00	.00	250.00
2022 021-621-442	WATER	.00	300.00	20.00	160.00	53.33	140.00
2022 021-621-458	BRIDGE REPAIRS	.00	1,000.00	.00	.00	.00	1,000.00
2022 021-621-460	RENTS & LEASES	.00	8,000.00	29.04	3,995.00	49.94	4,005.00
2022 021-621-461	REIMBURSEMENTS	.00	.00	.00	.00	.00	.00
2022 021-621-482	INSURANCE	.00	2,000.00	291.00	734.00	36.70	1,266.00
2022 021-621-486	CONTRACT LABOR	.00	3,000.00	.00	.00	.00	3,000.00
2022 021-621-490	MISC	.00	1,524.44	.00	.00	.00	1,524.44
2022 021-621-492	REGISTRATIONS & INSPECTION	.00	29.00	.00	29.00	100.00	.00
2022 021-621-550	EMERGENCIES	.00	.00	.00	.00	.00	.00
2022 021-621-570	CAPITAL INVESTMENTS	.00	.00	.00	.00	.00	.00
2022 021-621-700	TRANSFER FUNDS	.00	.00	.00	.00	.00	.00
	TOTAL EXP	.00	236,676.33	12,654.95	117,375.03	49.59	119,301.30
2022 021-999-990	ACTUAL EXPENDITURES	.00	.00	.00	.00	.00	.00
	FUND TOTAL	.00	236,676.33	12,654.95	117,375.03	49.59	119,301.30

64.51% OF YEAR COMPLETED

ROAD & BRIDGE PCT#2

ACCOUNT NO	ACCOUNT NAME	ENCUMBRANCE	BUDGET	** ACTUAL ** M-T-D	*** ACTUAL *** Y-T-D	**** ACTUAL **** REMAINING PERCENT
2022 022-622-000	ROAD & BRIDGE 2	.00	.00	.00	.00	.00
2022 022-622-101	COMMISSIONER'S SALARY	.00	45,000.00	3,461.54	29,423.09	15,576.91
2022 022-622-106	ROAD WORKER SALARIES	.00	28,737.46	2,485.98	21,130.83	7,606.63
2022 022-622-107	PAY FOR PERFORMANCE	.00	.00	.00	.00	.00
2022 022-622-108	OVERTIME	.00	.00	.00	.00	.00
2022 022-622-109	FOREMAN	.00	32,317.77	2,210.58	18,789.93	13,527.84
2022 022-622-150	LONGEVITY PAY	.00	.00	.00	.00	.00
2022 022-622-201	PAYROLL TAXES	.00	8,113.23	623.30	5,298.05	2,815.18
2022 022-622-202	HEALTH INSURANCE	.00	6,137.56	.00	.00	6,137.56
2022 022-622-203	RETIREMENT	.00	7,073.88	544.14	4,625.19	2,448.69
2022 022-622-204	WORKMAN COMP	.00	1,651.53	.00	498.88	1,152.65
2022 022-622-205	UNIFORMS/PROTECTIVE EQUIPMEN	.00	400.00	.00	.00	400.00
2022 022-622-206	UNEMPLOYMENT	.00	30.53	.00	15.26	15.27
2022 022-622-207	DEATH BENEFIT	.00	593.91	44.06	380.99	212.92
2022 022-622-310	SHOP SUPPLIES	.00	1,000.00	184.88	502.90	497.10
2022 022-622-330	GAS & OIL	.00	12,000.00	351.14	8,535.97	3,464.03
2022 022-622-340	ROAD OIL & ROCK	.00	35,000.00	.00	2,879.24	32,120.76
2022 022-622-341	MATERIAL	.00	1,000.00	.00	632.58	367.42
2022 022-622-342	TIN HORNS	.00	2,500.00	.00	.00	2,500.00
2022 022-622-343	CHEMICALS	.00	500.00	.00	.00	500.00
2022 022-622-352	REPAIRS	.00	14,000.00	506.67	8,284.00	5,716.00
2022 022-622-353	TOOLS	.00	1,000.00	.00	15.98	984.02
2022 022-622-400	ATTORNEY FEES	.00	1,400.00	.00	428.22	971.78
2022 022-622-401	CENTRAL APPRAISAL DISTRICT	.00	.00	.00	.00	.00
2022 022-622-406	DELTA COUNTY APPRAISAL DIST.	.00	6,217.00	1,554.38	4,663.14	1,553.86
2022 022-622-413	OTHER GOVERNMENTS	.00	500.00	.00	745.49	212.51
2022 022-622-420	TELEPHONE	.00	1,200.00	93.03	250.00	454.51
2022 022-622-421	CELL PHONE	.00	.00	.00	.00	250.00
2022 022-622-427	EDUCATION/TRAVEL	.00	1,200.00	.00	.00	1,200.00
2022 022-622-440	ELECTRICITY	.00	700.00	59.51	367.91	332.09
2022 022-622-441	GAS/PROPANE	.00	300.00	.00	.00	300.00
2022 022-622-442	WATER	.00	700.00	42.21	337.68	362.32
2022 022-622-458	BRIDGE REPAIRS	.00	500.00	.00	.00	500.00
2022 022-622-460	RENTS & LEASES	.00	4,000.00	.00	.00	4,000.00
2022 022-622-461	REIMBURSEMENTS	.00	.00	.00	.00	.00
2022 022-622-482	INSURANCE	.00	2,000.00	168.00	891.00	1,109.00
2022 022-622-486	CONTRACT LABOR	.00	500.00	.00	.00	500.00
2022 022-622-490	MISC	.00	2,362.44	.00	73.45	2,288.99
2022 022-622-492	REGISTRATIONS & INSPECTION	.00	100.00	.00	29.50	70.50
2022 022-622-550	EMERGENCIES	.00	.00	.00	.00	.00
2022 022-622-570	CAPITAL INVESTMENTS	.00	.00	.00	.00	.00
2022 022-622-700	TRANSFER FUNDS	.00	.00	.00	.00	.00
	TOTAL EXP	.00	218,735.31	12,329.42	109,087.28	109,648.03
2022 022-999-990	ACTUAL EXPENDITURES	.00	.00	.00	.00	.00
	FUND TOTAL	.00	218,735.31	12,329.42	109,087.28	109,648.03

ACCOUNT NO	ACCOUNT NAME	ENCUMBRANCE	BUDGET	** ACTUAL ** M-T-D	*** ACTUAL *** Y-T-D	PERCENT	PERCENT	**** ACTUAL **** REMAINING	PERCENT
2022 023-623-000	ROAD & BRIDGE 3	.00	.00	.00	.00	.00	.00	.00	.00
2022 023-623-101	COMMISSIONER'S SALARY	.00	45,000.00	3,461.54	29,423.09	65.38	15,576.91	34.62	34.62
2022 023-623-106	ROAD WORKER SALARIES	.00	27,621.55	.00	2,275.64	8.24	25,345.91	91.76	91.76
2022 023-623-107	PAY FOR PERFORMANCE	.00	.00	.00	.00	.00	.00	.00	.00
2022 023-623-108	OVERTIME	.00	.00	.00	.00	.00	.00	.00	.00
2022 023-623-109	FOREMAN	.00	36,395.06	2,799.62	23,796.77	65.38	12,598.29	34.62	34.62
2022 023-623-150	LONGEVITY PAY	.00	.00	.00	.00	.00	.00	.00	.00
2022 023-623-201	PAYROLL TAXES	.00	8,339.77	486.02	4,332.39	51.95	4,007.38	48.05	48.05
2022 023-623-202	HEALTH INSURANCE	.00	6,137.56	.00	.00	.00	6,137.56	100.00	100.00
2022 023-623-203	RETIREMENT	.00	7,271.41	430.96	3,808.29	52.37	3,463.12	47.63	47.63
2022 023-623-204	WORKMAN COMP	.00	1,725.21	.00	498.86	28.92	1,226.35	71.08	71.08
2022 023-623-205	UNIFORMS/PROTECTIVE EQUIPMEN	.00	1,000.00	.00	.00	.00	1,000.00	100.00	100.00
2022 023-623-206	UNEMPLOYMENT	.00	32.01	.00	10.24	31.99	21.77	68.01	68.01
2022 023-623-207	DEATH BENEFIT	.00	610.49	34.90	313.93	51.42	296.56	48.58	48.58
2022 023-623-225	FUEL ALLOWANCE	.00	2,400.00	200.00	1,600.00	66.67	800.00	33.33	33.33
2022 023-623-310	SHOP SUPPLIES	.00	1,600.00	16.55	358.75	22.42	1,241.25	77.58	77.58
2022 023-623-330	GAS & OIL	.00	16,000.00	167.78	8,408.68	52.55	7,591.32	47.45	47.45
2022 023-623-340	ROAD OIL & ROCK	.00	30,000.00	.00	3,242.03	10.81	26,757.97	89.19	89.19
2022 023-623-341	MATERIAL	.00	2,000.00	.00	2,111.70	105.59	111.70	5.59	5.59
2022 023-623-342	TIN HORNS	.00	4,000.00	.00	733.70	18.34	3,266.30	81.66	81.66
2022 023-623-343	CHEMICALS	.00	3,000.00	.00	742.99	24.76	2,257.01	75.24	75.24
2022 023-623-352	REPAIRS	.00	14,000.00	647.69	7,429.99	53.07	6,570.01	46.93	46.93
2022 023-623-353	TOOLS	.00	1,400.00	.00	.00	.00	1,400.00	100.00	100.00
2022 023-623-400	ATTORNEY FEES	.00	1,400.00	.00	428.24	30.59	971.76	69.41	69.41
2022 023-623-401	CENTRAL APPRAISAL DISTRICT	.00	.00	.00	.00	.00	.00	.00	.00
2022 023-623-406	DELTA COUNTY APPRAISAL DIST.	.00	6,217.00	1,554.38	4,663.14	75.01	1,553.86	24.99	24.99
2022 023-623-413	OTHER GOVERNMENTS	.00	600.00	.00	288.00	48.00	312.00	52.00	52.00
2022 023-623-420	TELEPHONE	.00	700.00	55.66	445.28	63.61	254.72	36.39	36.39
2022 023-623-421	CELL PHONE	.00	250.00	.00	125.00	50.00	125.00	50.00	50.00
2022 023-623-427	EDUCATION/TRAVEL	.00	750.00	.00	293.39	39.12	456.61	60.88	60.88
2022 023-623-440	ELECTRICITY	.00	600.00	26.05	230.74	38.46	369.26	61.54	61.54
2022 023-623-441	GAS	.00	300.00	.00	.00	.00	300.00	100.00	100.00
2022 023-623-442	WATER	.00	300.00	20.00	160.00	53.33	140.00	46.67	46.67
2022 023-623-458	BRIDGE REPAIRS	.00	1,500.00	.00	160.00	10.67	1,340.00	89.33	89.33
2022 023-623-460	RENTS & LEASES	.00	10,000.00	1,122.92	10,183.36	101.83	183.36	1.83	1.83
2022 023-623-461	REIMBURSEMENTS	.00	.00	.00	.00	.00	.00	.00	.00
2022 023-623-482	INSURANCE	.00	2,000.00	278.00	992.00	49.60	1,008.00	50.40	50.40
2022 023-623-486	CONTRACT LABOR	.00	3,000.00	.00	150.00	5.00	2,850.00	95.00	95.00
2022 023-623-490	MISC	.00	2,362.44	.00	66.00	2.79	2,296.44	97.21	97.21
2022 023-623-492	REGISTRATIONS & INSPECTION	.00	200.00	15.00	66.00	33.00	134.00	67.00	67.00
2022 023-623-550	EMERGENCIES	.00	.00	.00	.00	.00	.00	.00	.00
2022 023-623-570	CAPITAL INVESTMENTS	.00	10,000.00	.00	10,000.00	100.00	.00	.00	.00
2022 023-623-700	TRANSFER FUNDS	.00	.00	.00	.00	.00	.00	.00	.00
2022 023-623-700	TOTAL EXPENSES	.00	248,712.50	11,317.07	116,369.21	46.79	132,343.29	53.21	53.21
2022 023-999-990	ACTUAL EXPENDITURES	.00	.00	11,317.07	116,369.21	46.79	132,343.29	53.21	53.21
	FUND TOTAL	.00	248,712.50	11,317.07	116,369.21	46.79	132,343.29	53.21	53.21

64.51% OF YEAR COMPLETED

ROAD & BRIDGE PCT#4

ACCOUNT NO	ACCOUNT NAME	ENCUMBRANCE	BUDGET	** ACTUAL ** M-T-D	*** ACTUAL *** Y-T-D	PERCENT	**** ACTUAL **** REMAINING	PERCENT
2022 024-624-000	ROAD & BRIDGE 4	.00	.00	.00	.00	.00	.00	.00
2022 024-624-101	COMMISSIONER'S SALARY	.00	45,000.00	3,461.54	29,423.09	65.38	15,576.91	34.62
2022 024-624-106	ROAD WORKER SALARIES	.00	30,496.42	2,345.88	19,939.98	65.38	10,556.44	34.62
2022 024-624-107	PAY FOR PERFORMANCE	.00	.00	.00	.00	.00	.00	.00
2022 024-624-108	OVERTIME	.00	.00	.00	.00	.00	.00	.00
2022 024-624-109	FOREMAN	.00	36,395.06	2,799.62	23,796.77	65.38	12,598.29	34.62
2022 024-624-150	LONGEVITY PAY	.00	.00	.00	.00	.00	.00	.00
2022 024-624-201	PAYROLL TAXES	.00	8,559.70	649.68	5,522.28	64.51	3,037.42	35.49
2022 024-624-202	HEALTH INSURANCE	.00	6,137.55	.00	.00	.00	6,137.55	100.00
2022 024-624-203	RETIREMENT	.00	7,463.16	574.10	4,879.85	65.39	2,583.31	34.61
2022 024-624-204	WORKMAN COMP	.00	1,796.75	.00	498.88	27.77	1,297.87	72.23
2022 024-624-205	UNIFORMS/PROTECTIVE EQUIPMEN	.00	750.00	.00	.00	.00	750.00	100.00
2022 024-624-206	UNEMPLOYMENT	.00	33.45	.00	16.72	49.99	16.73	50.01
2022 024-624-207	DEATH BENEFIT	.00	626.59	46.48	401.96	64.15	224.63	35.85
2022 024-624-310	OPERATING SUPPLIES	.00	750.00	.00	45.31	11.96	45.31	100.00
2022 024-624-313	SHOP SUPPLIES	.00	10,000.00	.00	89.70	11.96	660.30	88.04
2022 024-624-330	GAS & OIL	.00	10,000.00	429.11	6,375.48	63.75	3,624.52	36.25
2022 024-624-340	ROAD OIL & ROCK	.00	45,000.00	.00	12,374.71	27.50	32,625.29	72.50
2022 024-624-341	MATERIAL	.00	2,500.00	.00	.00	.00	2,500.00	100.00
2022 024-624-342	TIN HORNS	.00	5,000.00	.00	.00	.00	5,000.00	100.00
2022 024-624-343	CHEMICALS	.00	500.00	.00	18.99	3.80	481.01	96.20
2022 024-624-352	REPAIRS	.00	20,000.00	247.96	7,747.49	38.74	12,252.51	61.26
2022 024-624-353	TOOLS	.00	750.00	.00	10.69	1.43	739.31	98.57
2022 024-624-400	ATTORNEY FEES	.00	1,400.00	.00	428.23	30.59	971.77	69.41
2022 024-624-401	CENTRAL APPRAISAL DISTRICT	.00	.00	.00	.00	.00	.00	.00
2022 024-624-406	DELTA COUNTY APPRAISAL DIST.	.00	6,217.00	1,554.39	4,663.17	75.01	1,553.83	24.99
2022 024-624-413	OTHER GOVERNMENTS	.00	800.00	.00	288.00	48.00	312.00	52.00
2022 024-624-420	TELEPHONE	.00	883.00	92.52	634.05	71.81	248.95	28.19
2022 024-624-421	CELL PHONE	.00	250.00	.00	250.00	100.00	.00	.00
2022 024-624-427	EDUCATION/TRAVEL	.00	1,500.00	.00	1,290.18	86.01	209.82	13.99
2022 024-624-440	ELECTRICITY	.00	600.00	24.15	1,262.93	43.82	337.07	56.18
2022 024-624-441	GAS	.00	.00	.00	.00	.00	.00	.00
2022 024-624-442	WATER	.00	240.00	20.00	160.00	66.67	80.00	33.33
2022 024-624-458	BRIDGE REPAIRS	.00	1,500.00	.00	.00	.00	1,500.00	100.00
2022 024-624-460	RENTS & LEASES	.00	1,300.00	.00	800.00	61.54	500.00	38.46
2022 024-624-461	REIMBURSEMENTS	.00	.00	.00	.00	.00	.00	.00
2022 024-624-482	INSURANCE	.00	2,500.00	523.00	1,436.00	57.44	1,064.00	42.56
2022 024-624-486	CONTRACT LABOR	.00	5,000.00	.00	.00	.00	5,000.00	100.00
2022 024-624-490	MISC	.00	1,462.45	.00	43.50	43.50	1,462.45	100.00
2022 024-624-492	REGISTRATIONS & INSPECTION	.00	100.00	.00	.00	.00	56.50	56.50
2022 024-624-550	EMERGENCIES	.00	.00	.00	.00	.00	.00	.00
2022 024-624-570	CAPITAL INVESTMENTS	.00	.00	.00	.00	.00	.00	.00
2022 024-624-700	TRANSFER FUNDS	.00	.00	.00	.00	.00	.00	.00
	TOTAL EXPENSES	.00	245,311.13	12,768.43	121,397.96	49.49	123,913.17	50.51
2022 024-999-990	ACTUAL EXPENDITURES	.00	245,311.13	12,768.43	121,397.96	49.49	123,913.17	50.51
	FUND TOTAL	.00	245,311.13	12,768.43	121,397.96	49.49	123,913.17	50.51
	FINAL TOTAL	.00	949,435.27	49,069.87	464,229.48	48.90	485,205.79	51.10

ACCOUNT NO	ACCOUNT NAME	ENCUMBRANCE	BUDGET	** ACTUAL M-T-D	** ACTUAL Y-F-D	PERCENT	**** ACTUAL REMAINING PERCENT
2022 010-409-000	NON-DEPARTMENTAL	.00	.00	.00	.00	.00	.00
2022 010-409-202	EMPLOYEE HEALTH INSURANCE	.00	38,693.57	.00	.00	.00	38,693.57 100.00
2022 010-409-204	WORKMAN COMP	.00	1,784.00	.00	.00	.00	1,784.00 100.00
2022 010-409-310	COUNTY OFFICE SUPPLIES	.00	6,500.00	1,524.82	.00	96.91	201.01 3.09
2022 010-409-311	POSTAGE	.00	7,000.00	73.68	5,311.92	75.88	1,688.08 24.12
2022 010-409-312	POSTAGE METER RENT	.00	2,856.66	.00	1,190.25	41.67	1,666.41 58.33
2022 010-409-400	MURDER TRIAL	.00	.00	.00	.00	.00	.00 .00
2022 010-409-401	OTHER GOVERNMENTS	.00	133,604.00	.00	68,383.34	51.18	65,220.66 48.82
2022 010-409-402	I TICKET	.00	.00	.00	.00	.00	.00 .00
2022 010-409-403	OUTSIDE COUNTY AUDIT	.00	13,000.00	.00	.00	.00	13,000.00 100.00
2022 010-409-404	PC 30	.00	.00	.00	.00	.00	.00 .00
2022 010-409-408	CRIMES SOFTWARE	.00	26,000.00	.00	18,750.00	72.12	7,250.00 27.88
2022 010-409-420	TELEPHONE	.00	11,044.85	912.61	7,299.86	66.09	3,745.00 33.91
2022 010-409-421	TELEPHONE MAINTENANCE	.00	.00	.00	.00	.00	.00 .00
2022 010-409-430	PUBLIC NOTICE	.00	1,255.50	.00	1,020.50	81.28	235.00 18.72
2022 010-409-451	ELEVATOR MAINTENANCE	.00	2,835.95	.00	2,535.22	89.40	300.73 10.60
2022 010-409-452	COMPUTER MAINTENANCE	.00	12,000.00	1,200.00	7,646.14	63.72	4,353.86 36.28
2022 010-409-453	COPY MACHINE	.00	3,000.00	232.38	2,298.76	76.63	701.24 23.37
2022 010-409-481	AIRMED CARE DUES	.00	.00	.00	.00	.00	.00 .00
2022 010-409-482	INSURANCE	.00	29,500.00	.00	30,064.00	101.91	564.00- .00
2022 010-409-490	MISCELLANEOUS	.00	10,250.00	195.30	10,259.46	100.09	9.46- .09-*
2022 010-409-491	ECONOMIC DEVELOPMENT	.00	.00	.00	.00	.00	.00 .00
2022 010-409-550	GRANTS	.00	57,200.00	.00	.00	.00	57,200.00 100.00
2022 010-409-560	CONTINGENCY	.00	25,399.59	.00	25,399.59	100.00	.00 .00
2022 010-409-580	HOMELAND SECURITY GRANT	.00	.00	.00	.00	.00	.00 .00
2022 010-409-581	RIGHT OF WAY	.00	.00	.00	.00	.00	.00 .00
2022 010-409-610	DEBT SERVICE	.00	.00	.00	.00	.00	.00 .00
2022 010-409-650	INTEREST EXPENSE	.00	.00	.00	.00	.00	.00 .00
2022 010-409-700	TRANSFER FUNDS	.00	381,924.13	20,854.79	186,458.03	48.82	195,466.10 51.18
	TOTAL NON-DEPARTMENTAL	.00	381,924.13	20,854.79	186,458.03	48.82	195,466.10 51.18
	FINAL TOTAL	.00	381,924.13	20,854.79	186,458.03	48.82	195,466.10 51.18

63.71% OF YEAR COMPLETED ROAD & BRIDGE PCT#1

ACCOUNT NO	ACCOUNT NAME	ENCUMBRANCE	BUDGET	** ACTUAL M-T-D	*** ACTUAL Y-T-D	**** ACTUAL PERCENT	***** ACTUAL REMAINING PERCENT
2022 021-621-000	ROAD & BRIDGE 1	.00	.00	.00	.00	.00	.00
2022 021-621-101	COMMISSIONER'S SALARY	.00	45,000.00	3,461.54	29,423.09	65.38	15,576.91
2022 021-621-106	ROAD WORKER SALARIES	.00	29,898.45	2,299.88	19,548.98	65.38	10,349.47
2022 021-621-107	PAY FOR PERFORMANCE	.00	.00	.00	.00	.00	.00
2022 021-621-108	OVERTIME	.00	.00	.00	.00	.00	.00
2022 021-621-109	FOREMAN	.00	36,395.06	2,799.62	23,796.77	65.38	12,598.29
2022 021-621-150	LONGEVITY PAY	.00	.00	.00	.00	.00	.00
2022 021-621-201	PAYROLL TAXES	.00	8,513.95	685.54	5,811.79	68.26	2,702.16
2022 021-621-202	HEALTH INSURANCE	.00	7,500.00	.00	5,067.11	68.26	2,432.89
2022 021-621-203	RETIREMENT	.00	7,423.28	597.70	4,988.88	68.26	2,434.40
2022 021-621-204	WORKMAN COMP	.00	1,781.20	.00	1,781.20	100.00	.00
2022 021-621-205	UNIFORMS/PROTECTIVE EQUIPMENT	.00	1,000.00	.00	.00	.00	1,000.00
2022 021-621-206	UNEMPLOYMENT	.00	33.15	.00	16.57	49.98	16.58
2022 021-621-207	DEATH BENEFIT	.00	623.24	48.40	417.36	66.97	205.88
2022 021-621-225	FUEL ALLOWANCE	.00	4,800.00	400.00	3,200.00	66.67	1,600.00
2022 021-621-310	SHOP SUPPLIES	.00	1,000.00	34.70	139.12	13.91	860.88
2022 021-621-330	GAS & OIL	.00	12,500.00	177.09	9,279.07	74.23	3,220.93
2022 021-621-340	ROAD OIL & ROCK	.00	35,000.00	.00	3,211.72	9.18	31,788.28
2022 021-621-341	MATERIAL	.00	2,500.00	.00	.00	.00	2,500.00
2022 021-621-342	TIN HORNS	.00	3,500.00	.00	358.20	10.23	3,141.80
2022 021-621-343	CHEMICALS	.00	500.00	.00	.00	.00	500.00
2022 021-621-352	REPAIRS	.00	10,000.00	216.10	4,100.64	41.01	5,899.36
2022 021-621-353	TOOLS	.00	1,500.00	.00	35.68	2.38	1,464.32
2022 021-621-400	ATTORNEY FEES	.00	1,400.00	.00	428.23	30.59	971.77
2022 021-621-401	CENTRAL APPRAISAL DISTRICT	.00	.00	.00	.00	.00	.00
2022 021-621-406	DELTA COUNTY APPRAISAL DIST.	.00	6,217.00	1,554.38	4,663.14	75.01	1,553.86
2022 021-621-413	OTHER GOVERNMENTS	.00	500.00	.00	288.00	57.60	212.00
2022 021-621-420	TELEPHONE	.00	850.00	.00	550.16	64.72	299.84
2022 021-621-421	CELL PHONE	.00	250.00	.00	250.00	100.00	.00
2022 021-621-427	EDUCATION/TRAVEL	.00	2,500.00	.00	710.65	28.43	1,789.35
2022 021-621-440	ELECTRICITY	.00	750.00	39.96	661.87	88.25	88.13
2022 021-621-441	GAS	.00	250.00	.00	.00	.00	250.00
2022 021-621-442	WATER	.00	300.00	20.00	160.00	53.33	140.00
2022 021-621-458	BRIDGE REPAIRS	.00	1,000.00	.00	.00	.00	1,000.00
2022 021-621-460	RENTS & LEASES	.00	8,000.00	29.04	3,995.00	49.94	4,005.00
2022 021-621-461	REIMBURSEMENTS	.00	.00	.00	.00	.00	.00
2022 021-621-482	INSURANCE	.00	2,000.00	291.00	734.00	36.70	1,266.00
2022 021-621-486	CONTRACT LABOR	.00	3,000.00	.00	.00	.00	3,000.00
2022 021-621-490	MISC	.00	162.00	.00	.00	.00	162.00
2022 021-621-492	REGISTRATIONS & INSPECTION	.00	29.00	.00	29.00	100.00	.00
2022 021-621-550	EMERGENCIES	.00	.00	.00	.00	.00	.00
2022 021-621-570	CAPITAL INVESTMENTS	.00	.00	.00	.00	.00	.00
2022 021-621-570	TRANSFER FUNDS	.00	.00	.00	.00	.00	.00
2022 021-621-700	TOTAL EXP	.00	236,676.33	12,654.95	117,375.03	49.59	119,301.30
2022 021-999-990	ACTUAL EXPENDITURES	.00	.00	12,654.95	117,375.03	49.59	119,301.30
	FUND TOTAL	.00	236,676.33	12,654.95	117,375.03	49.59	119,301.30

ACCOUNT NO	ACCOUNT NAME	ENCUMBRANCE	BUDGET	** ACTUAL ** M-T-D	*** ACTUAL *** Y-T-D	PERCENT	**** ACTUAL **** REMAINING PERCENT
2022 022-622-000	ROAD & BRIDGE 2	.00	.00	.00	.00	.00	.00
2022 022-622-101	COMMISSIONER'S SALARY	.00	45,000.00	3,461.54	29,423.09	65.38	15,576.91
2022 022-622-106	ROAD WORKER SALARIES	.00	28,737.46	2,485.98	21,130.83	73.53	7,606.63
2022 022-622-107	PAY FOR PERFORMANCE	.00	.00	.00	.00	.00	.00
2022 022-622-108	OVERTIME	.00	.00	.00	.00	.00	.00
2022 022-622-109	FOREMAN	.00	32,317.77	2,210.58	18,789.93	58.14	13,527.84
2022 022-622-150	LONGEVITY PAY	.00	.00	.00	.00	.00	.00
2022 022-622-201	PAYROLL TAXES	.00	8,113.23	623.30	5,298.05	65.30	2,815.18
2022 023-622-202	HEALTH INSURANCE	.00	7,500.00	.00	.00	.00	7,500.00
2022 022-622-203	RETIREMENT	.00	7,073.88	544.14	4,625.19	65.38	2,448.69
2022 022-622-204	WORKMAN COMP	.00	1,651.53	.00	498.88	30.21	1,152.65
2022 022-622-205	UNIFORMS/PROTECTIVE EQUIPMEN	.00	400.00	.00	.00	.00	400.00
2022 023-622-206	UNEMPLOYMENT	.00	30.53	.00	15.26	49.18	15.27
2022 022-622-207	DEATH BENEFIT	.00	593.91	44.06	380.99	64.15	212.92
2022 022-622-310	SHOP SUPPLIES	.00	1,000.00	184.88	502.90	50.29	497.10
2022 022-622-330	GAS & OIL	.00	12,000.00	184.88	8,535.97	71.13	3,464.03
2022 022-622-340	ROAD OIL & ROCK	.00	35,000.00	351.14	2,879.24	8.23	32,120.76
2022 022-622-341	MATERIAL	.00	1,000.00	.00	632.58	63.26	367.42
2022 022-622-342	TIN HORNS	.00	2,500.00	.00	.00	.00	2,500.00
2022 022-622-343	CHEMICALS	.00	500.00	.00	8,284.00	59.17	5,716.00
2022 022-622-352	REPAIRS	.00	14,000.00	506.67	15.98	1.60	984.02
2022 022-622-353	TOOLS	.00	1,000.00	.00	428.22	30.59	571.78
2022 022-622-400	ATTORNEY FEES	.00	1,400.00	.00	15.98	1.60	1,384.02
2022 022-622-401	CENTRAL APPRAISAL DISTRICT	.00	6,217.00	1,554.38	4,663.14	75.01	1,553.86
2022 022-622-406	DELTA COUNTY APPRAISAL DIST.	.00	500.00	93.03	288.00	57.60	212.00
2022 022-622-413	OTHER GOVERNMENTS	.00	1,200.00	93.03	745.49	62.12	454.51
2022 022-622-420	TELEPHONE	.00	1,200.00	.00	250.00	20.83	950.00
2022 022-622-421	CELL PHONE	.00	1,200.00	.00	.00	.00	1,200.00
2022 022-622-427	EDUCATION/TRAVEL	.00	300.00	59.51	367.91	52.56	332.09
2022 022-622-440	ELECTRICITY	.00	300.00	.00	.00	.00	300.00
2022 022-622-441	GAS/PROPANE	.00	700.00	42.21	337.68	48.24	362.32
2022 022-622-442	WATER	.00	500.00	.00	.00	.00	500.00
2022 022-622-458	BRIDGE REPAIRS	.00	4,000.00	.00	.00	.00	4,000.00
2022 022-622-460	RENTS & LEASES	.00	2,000.00	.00	891.00	44.55	1,109.00
2022 022-622-461	REIMBURSEMENTS	.00	500.00	.00	.00	.00	500.00
2022 022-622-482	INSURANCE	.00	1,000.00	168.00	73.45	7.35	926.55
2022 022-622-486	CONTRACT LABOR	.00	100.00	.00	29.50	29.50	70.50
2022 022-622-490	MISC	.00	100.00	.00	.00	.00	100.00
2022 022-622-492	REGISTRATIONS & INSPECTION	.00	.00	.00	.00	.00	.00
2022 022-622-550	EMERGENCIES	.00	.00	.00	.00	.00	.00
2022 022-622-570	CAPITAL INVESTMENTS	.00	.00	.00	.00	.00	.00
2022 022-622-700	TRANSFER FUNDS	.00	218,735.31	12,329.42	109,087.28	49.87	109,648.03
2022 022-622-700	TOTAL EXP	.00	218,735.31	12,329.42	109,087.28	49.87	109,648.03
2022 022-999-990	ACTUAL EXPENDITURES	.00	218,735.31	12,329.42	109,087.28	49.87	109,648.03
	FUND TOTAL	.00	218,735.31	12,329.42	109,087.28	49.87	109,648.03

*

THIS IS TO CERTIFY THAT I, JANE JONES, COUNTY CLERK DO EREBY CERTIFY TO
THE CORRECTNESS OF THE MINUTES OF May 23, 2022 THIS THE 23
DAY OF June, 2022.

Jane Jones

MB

George Hunt

Mark Brantley

Moyna Ph

Jane Jones
JANE JONES, CLERK

